



**TRAVELERS**  
CHAMPIONSHIP

# **VOLUNTEER HANDBOOK**

**JUNE 19-25, 2023 | TPC RIVER HIGHLANDS | CROMWELL, CT**



**FedEx**



# TABLE OF CONTENTS

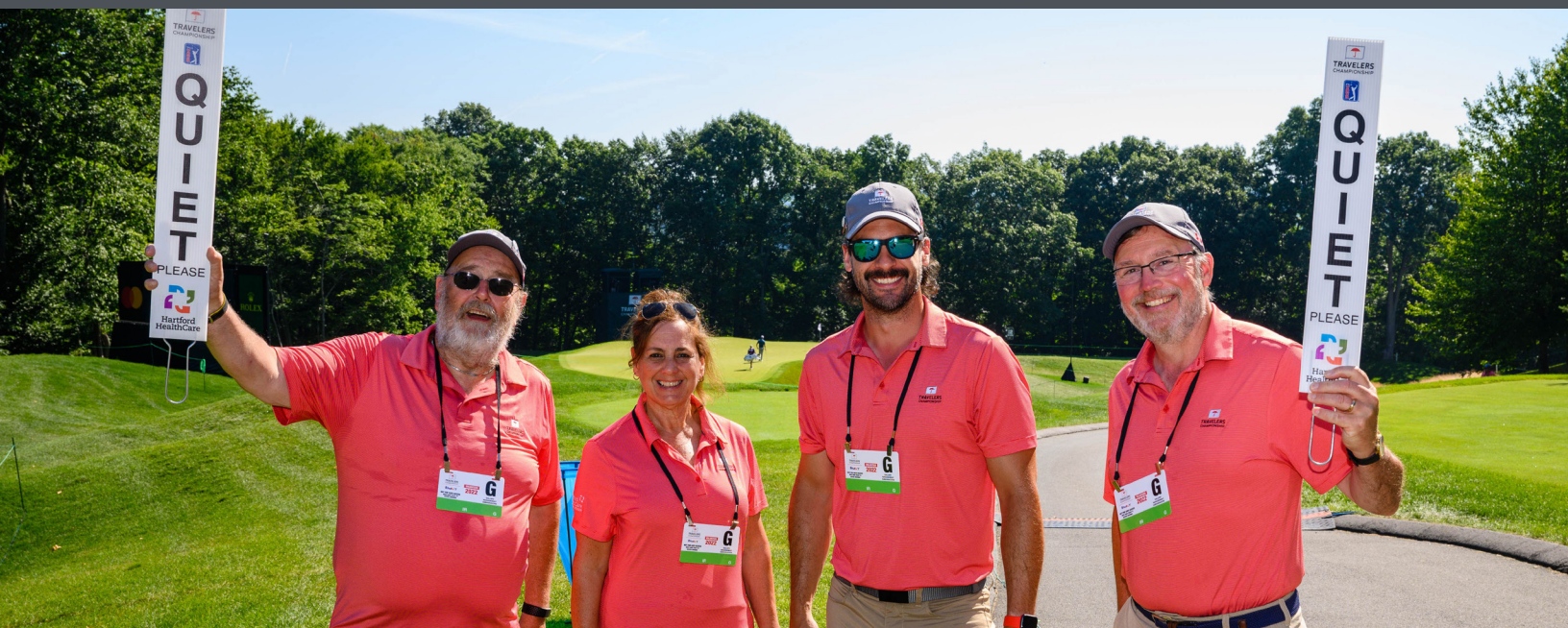

How Can We Help?.....	3
2023 Executive Committee & Assistants.....	4
A-Z Information.....	5
Volunteer Code of Conduct.....	6
ADA Parking.....	7
ADA Viewing Locations.....	7
Admission Gate Locations & Hours.....	7
Arrival.....	7
Autograph Policy.....	7
Concession Stand Locations & Hours.....	8
Credentials & Parking.....	9
Emergencies.....	9
Fan Services Locations.....	9
Food & Beverage.....	10
Golf Carts.....	10
Golf Etiquette.....	10
Helpful Hints.....	10
Hospitality Locations & Hours.....	11
Open to All Fans Locations & Hours.....	12
Important Contact Numbers.....	12
Lost and Found.....	12
Medical.....	12
Personal Belongings.....	12
Public Restrooms.....	12
Security Policy.....	13
Uniform.....	15
Volunteer Awards.....	16
Volunteer Lounge in the Fan Zone.....	16
Volunteer Party.....	17
Volunteer Shuttle Program.....	18
Weather Alert Scale.....	19
Maps & Hospitality Information.....	20
Stanley Black & Decker Fan Zone.....	19
18th Hole Hospitality.....	21
17th Hole Hospitality.....	22
A-Z Hospitality Clients.....	23
Course Map.....	24

# HOW CAN WE HELP?

The tournament operates a text communications system that can be used for guest services and operational issues. Signage will be located around the course with this information.

**Text issue and location to 860-86(4-HELP)  
(860-864-4357)**



Below are a few examples of when to use the texting system:

- Bathroom Maintenance
- Tripping Hazards
- Lost and Found Items

# 2023 EXECUTIVE COMMITTEE

All Executive Committee members wear purple shirts during tournament week to help make them easily identifiable.

## AIRPORT CONCIERGE

Jim Anderson  
Jennifer Bouquot

## AMATEUR CADDIES

Marc Zirolli  
Asst: Steve Zirolli

## COMPETITION SUPPORT

Nick Guiliano

## COMPETITION SUPPORT: LOCATION BASED OPERATORS

Joseph "Woody" Mrozowski

## COMPETITION SUPPORT: WALKING SCORERS

Charles "Buddy" Buder  
Brian Zimmerli

## DISTRIBUTION

Ray Shaw

## FAN SERVICES

Monica Zapatka  
Asst: Ellen Farber

## FAN ZONE

Jennifer Shea  
Asst: Jessica Hyde-Cadogen

## GALLERY MANAGEMENT

Maureen O'Connor  
Asst: Diane Fuore  
Asst: Greg Hammond  
Asst: Karen Orton

## GATES

Sam Guerra  
Asst: Erick Hernandez

## HOSPITALITY: 17TH GREEN

Danielle Sobocinski

## HOSPITALITY: 17TH TEE

Richard Sinclair  
Asst: Cathy Welskopp

## HOSPITALITY: 18TH HOLE

Art Kuever  
Asst: Lucian Terranova  
Asst: Mark Vining  
Asst: Richard Steere

## MEDIA SHUTTLE

Richard Laury  
Asst: Jeff Miller

## MILITARY APPRECIATION

Glenn Murray  
Sharon O'Brien

## PLAYER SHUTTLES

Michelle Clark  
Jay Dykstra

## PLAYER RELATIONS

Drew Gallup  
Asst: David May

## PLAYER TRANSPORTATION

Donna Stepanek  
Asst: Dawn Kirkwood  
Asst: Mike DeHetre

## PRACTICE FACILITY

Kristin Wirtanen  
Asst: Joe Milositz

## PRO-AM

Mike Maksymiw  
Thomas Kim

## PRO-CADDIE HOSPITALITY

Maggie Pastore  
David Timm

## SPECIAL ASSISTANCE SHUTTLE

Anne Martin  
Bryan Fix

## STANDARD BEARERS

Jeff Levine  
Asst: Kyle Fitzgerald

## STARTERS

John Shulansky

## TICKET SERVICES

Meagan Mirkovich  
Asst: Nick Lapenta

## VOLUNTEER SERVICES

Rick Buckley  
Pam House

## VOLUNTEER VILLA

Erica Naumann

# A-Z INFORMATION



TRAVELERS

# VOLUNTEER CODE OF CONDUCT

The Travelers Championship appreciates your commitment and interest in volunteering at the 2023 event. Volunteers are subject to verification of eligibility by background and/or reference checks at the option of the Travelers Championship. The tournament expects its volunteers to conduct themselves with courtesy and professionalism and to remember that every person at the tournament, whether they are a player, volunteer or patron, deserves to be treated with consideration and respect. The tournament expects that all volunteers will be guided by this principle while volunteering at tournament events or representing the tournament in public. Therefore, the tournament offers these guidelines on how to conduct yourself, either on the grounds of the event or wherever you might be representing the tournament while in your volunteer uniform. Please note, this list is illustrative and not exhaustive of the behavior the tournament expects of its volunteers.

## **A VOLUNTEER MUST:**

- Wear the appropriate tournament approved uniform at all times while volunteering;
- Treat all patrons, players, fans, employees and fellow volunteers with courtesy and respect;
- Abide by all tournament policies and procedures;
- Follow all safety recommendations and protocols set by the tournament, CDC guidelines, and the PGA TOUR;
- Fulfill shift minimum requirements;
- Complete all shifts assigned unless otherwise communicated with the tournament or Committee Chair;
- Perform all tasks and duties asked by the Committee Chair;
- Be punctual.
- Read, be familiar with and agree to abide by the PGA TOUR Volunteer Integrity Program, which prohibits volunteers from betting on the Tournament.

## **A VOLUNTEER MUST NOT:**

- Consume alcohol or be under the influence of alcohol while in uniform;
- Smoke or be under the influence of any chemical or drugs;
- Violate any applicable law, regulation or ordinance;
- Engage in any type of discriminatory or harassing behavior on the basis of race, color, religion, gender, age, national origin, disability, marital status, sexual orientation, gender identity, veteran status, military status, genetic information or any other status or condition protected by local, state or federal law;
- Allow another individual to use your volunteer credentials;
- Seek autographs in alignment with the PGA TOUR autograph policy, solicit gratuities, gifts or bequests for personal or professional benefit;
- Enter restricted areas without proper credentials;
- Leave tasks or posts unattended;
- Use vulgar or offensive language;
- Resell tickets, credentials or tournament merchandise.

If you are aware of, or suspect, conduct that is unlawful or violates this Code of Conduct or tournament policies and procedures, please notify Taylor Whiting at [volunteers@travelerschampionship.com](mailto:volunteers@travelerschampionship.com).

A violation of this Code of Conduct may lead to immediate revocation of your volunteer credentials, expulsion from the tournament grounds and prevent you from volunteering at future events.

# A-Z INFORMATION

## ADA PARKING

Parking for spectators with disabilities will be available at Woodside Intermediate School (GPS Address: 30 Woodside Road, Cromwell, CT) for vehicles with a valid state permit. A complimentary wheelchair accessible shuttle will also be available from the lot to the main entrance from Monday, June 19 – Sunday, June 25.

Shuttle runs from 7 a.m. - 7 p.m.

*\*Open Monday & Tuesday for working staff only*

## ADA VIEWING LOCATIONS

There will be two ADA viewing locations on-site on hole 9 and 18 green as well as bleacher locations.

## ADMISSION GATE LOCATIONS AND HOURS

### **Main Gate: Accessible via Main Entrance and General Parking (Gold)**

6:30 a.m. – 5 p.m. | Wednesday – Friday

7:30 a.m. – 5 p.m. | Saturday – Sunday

### **9 Gate: Accessible via Red & Pink Lot Parking**

6:30 a.m. – 5 p.m. | Wednesday – Friday

7:30 a.m. – 5 p.m. | Saturday – Sunday

### **5/6 Gate: Accessible via Field Road**

6:30 a.m. – 5 p.m. | Wednesday – Friday

7:30 a.m. – 5 p.m. | Saturday – Sunday

## ARRIVAL

Please arrive on course with enough time before your shift to park, check-in, grab your breakfast, and walk to your committee meeting area. All volunteers will enter the **Volunteer Headquarters at 9 Gate** and check-in at the Volunteer Check-In trailer.

Remember to be respectful of others and watch your distance while waiting in line at the Volunteer Check-In trailer. Please check in each morning you are on course as you will receive food vouchers for the day. After checking in, you may pick up your breakfast inside the Volunteer Villa and utilize the rest of the Volunteer Headquarters area.

## AUTOGRAPH POLICY

To enhance the autograph experience, while allowing players to properly prepare for competition, the PGA TOUR has established the following guidelines:

- Autographs can only be obtained at the designated Autograph Zone at the Practice Facility
- On-course autographs are not permitted. This includes, but not limited to, tees, fairways, greens and practice areas and practice areas during practice and tournament rounds
- No memorabilia can be brought into the tournament including pin flags, photos, trading cards, balls and other sports paraphernalia

As a reminder, volunteers are not permitted to ask for autographs while volunteering and in uniform.

# A-Z INFORMATION

## CONCESSION STAND LOCATIONS AND HOURS

### **5/6th Hole (Express Location)**

10 a.m. – 6 p.m. | Wednesday – Friday

10 a.m. – 5 p.m. | Saturday – Sunday

### **8th Hole**

10 a.m. – 6 p.m. | Wednesday – Friday

10 a.m. – 5 p.m. | Saturday – Sunday

### **12th Hole (Express Location)**

10 a.m. – 7 p.m. | Wednesday – Sunday

### **15th Hole**

10 a.m. – 7 p.m. | Thursday – Sunday

### **Event Lawn (Express Location)**

10 a.m. – 7 p.m. | Wednesday – Sunday

### **Fan Zone North (Clubhouse Side)**

*Breakfast Available Until 10:30 a.m.*

7 a.m. – 7 p.m. | Wednesday – Sunday

### **Fan Zone South (17 Green Side)**

10 a.m. – 7 p.m. | Wednesday – Sunday

### **Fever-Tree Bar (Fan Zone Bar)**

10 a.m. – 1 hour prior to scheduled end of play | Wednesday – Sunday

### **Meiomi Wine Bar (Event Lawn Bar)**

10 a.m. – 1 hour prior to scheduled end of play | Wednesday – Sunday

### **Mount Gay Rum Shop (Practice Facility Bar)**

10 a.m. – 1 hour prior to scheduled end of play | Wednesday – Sunday

### **Practice Facility**

*Breakfast Available Until 10:30 a.m.*

7 a.m. – 7 p.m. | Wednesday – Sunday

### **Truly Bar (Fan Zone Bar)**

10 a.m. – 1 hour prior to scheduled end of play | Wednesday – Sunday



# A-Z INFORMATION

## CREDENTIALS & PARKING

All volunteer credentials will be digital, including parking passes. The volunteer digital credential is valid every day, Wednesday-Sunday, including days not volunteering.

“Inside the ropes” committees will receive a badge in your package that will allow “inside the ropes” access during volunteer shifts. All volunteers with this badge must keep it visible at all times.

## PARKING

All volunteers will be parking in the **Volunteer Lot (Pink Lot)**. Please follow all directional signage to the Volunteer Lot. Once you have turned onto the below GPS address, you will bear right at the first split. Do NOT go to the Gold Lot.

**GPS Address: 674 Main Street, Cromwell, CT**

Your digital volunteer credential will also function as your parking pass for the day of your shift. Just show your digital credential at the Volunteer Lot (Pink Lot) for parking. Volunteers will then proceed to the Volunteer Headquarters, which is located near 9 Gate.

## EMERGENCIES

If an emergency occurs, please dial 911 and notify the committee chair, a hole captain or staff member closest to you. They will radio the nearest Saint Francis Hospital Medical Center medical personnel if applicable.

## FAN SERVICES PRESENTED BY SEABOURN CRUISE LINE LOCATIONS

There are eight Fan Services presented by Seabourn posts at the Travelres Championship:

- 9/10 Crossover – Headquarters
- Clubhouse Crossover
- 1 Tee/Event Lawn
- 18 Green
- 17 Green
- Rideshare
- 9 Gate
- 9 Green



# A-Z INFORMATION

## FOOD & BEVERAGE

### BREAKFAST

- At the Check-In trailer each morning, volunteers will receive a breakfast voucher that will be able to be redeemed inside the Volunteer Villa tent only.
- Breakfast on Monday & Tuesday will be served from 6AM-10AM and from 5AM-10AM on Wednesday through Sunday.
- Breakfast items include a choice of bagel, muffin, and hot breakfast sandwich, along with whole fruit and greek yogurt. A gluten free option is available daily upon request.

### LUNCH

- At the Check-In trailer each morning, volunteers will receive a lunch voucher to be used at concession stands around the golf course. Please remember that the meal vouchers are day specific and cannot be redeemed for alcohol or apparel. Please see the back of the voucher for additional redemption details and locations.
- If you are apart of the Location Based Operators or Spotter committees, you will exchange your voucher with the committee chair and your meal will be delivered to your volunteer location on the golf course.

### WATER AND SNACKS

- Bottled water and snacks are available in the Volunteer Villa, as well as with the Volunteer Services committee who will be available on carts around course.
- Refillable water coolers are not available around course.
- Reusable plastic or metals cups/bottles are permitted if they are empty upon arrival. Please note, there will be no refillable water stations around course.

## GOLF CARTS

Any volunteer using a cart should use caution as to not interfere with play in any manner. Always operate with caution! Watching play while on a golf cart is strictly prohibited. Please follow all cart enforcements and policies throughout tournament week.

**All volunteers operating a golf cart must be at least 18 years old, have watched the video and signed the golf cart waiver.**

## GOLF ETIQUETTE

- Please be quiet when gallery management ambassadors raise their hands prior to any shot.
- Please wait for the gallery management ambassadors's signal before crossing any fairways.
- Please refrain from moving or walking when a player is preparing to hit a shot.
- Please respect the player's concentration and do not speak with them while on course.
- Unless instructed otherwise, please stay outside the ropes.

## HELPFUL HINTS

- Bring bug spray and sunscreen.
- Display your credential at all times.
- Drink plenty of fluids!
- Wear your volunteer hat or visor for protection from the sun.
- Treat every guest and volunteer of the tournament with the utmost kindness and respect.

# A-Z INFORMATION

## HOSPITALITY LOCATIONS AND HOURS

### HOSPITALITY TICKET REQUIRED:

#### CVS Health® Greenside Club

10 a.m. – 30 minutes post play | Wednesday – Sunday  
18th Green, Player Left

#### Champions Club presented by Omni Hotels & Resorts

10 a.m. – 30 minutes post play | Wednesday – Sunday  
18th Green, Player Right

#### Mohegan Sun Club

10 a.m. – 30 minutes post play | Thursday – Sunday  
17th Tee, Player Left

#### Skyboxes / Sky Suites

10 a.m. – 30 minutes post play | Wednesday – Sunday  
15th Green/18th Tee, 17th Green, 17th Tee, 18th Fairway

#### The Suite on 18

10 a.m. – 30 minutes post play | Thursday – Sunday  
18th Green, Player Right

#### Travelers 360

17th Green/15th Tee

#### Travelers Corporate Chalet

18th Green, Player Right

#### Travelers Trophy Suite

18th Green, Player Left



# A-Z INFORMATION

## **OPEN TO THE ALL FANS:**

### **Casamigos House of Friends**

10 a.m. – 30 minutes post play | Wednesday – Sunday  
9th Green, Player Left

### **Hartford HealthCare Sports Zone**

10 a.m. – 30 minutes post play | Wednesday – Sunday  
15th Tee/16th Green

### **Patriots' Outpost presented by Trinity Health Of New England**

(Active, Guard, Retired, Reserve Military Service Members and U.S. Veterans)  
10 a.m. – 30 minutes post play | Wednesday – Sunday  
9th Fairway, Player Left

### **Stanley Black & Decker Lounge**

10 a.m. – 30 minutes post play | Wednesday – Sunday  
18th Fairway, Player Left

### **Tito's Stillhouse Lounge**

10 a.m. – 30 minutes post play | Wednesday – Sunday  
17th Green, Player Left

## **IMPORTANT CONTACT NUMBERS**

Tournament Office:

Phone Number: 860-502-6800

Email: [info@travelerschampionship.com](mailto:info@travelerschampionship.com)

Tournament Staff Contact:

Taylor Whiting, Volunteer and Charity Manager

Email: [volunteers@travelerschampionship.com](mailto:volunteers@travelerschampionship.com)

## **LOST AND FOUND**

Text lost item and location to 1-860-86(4-HELP) to report something lost or found.

## **MEDICAL**

Medical Headquarters is located between the 9th Green and the Clubhouse. Medical services are provided by Saint Francis Hospital. There are satellite medical locations at holes 5/6, 12 and the 17 green side of the Fan Zone.

## **PERSONAL BELONGINGS**

Unfortunately, there are no locations for volunteers to store their personal belongings. We recommend that anything of value be left at home. Volunteers are allowed to bring in a bag that complies with our updated security policy.

## **PUBLIC RESTROOMS**

Public Restrooms are located throughout the course and are marked on the course map.

# A-Z INFORMATION

## SECURITY POLICY

Due to recent events and heightened security across our nation, the PGA TOUR and the Travelers Championship have updated the Security Policy to include mandatory screening of all patrons, sponsors, volunteers, media and vendors attending or working the event.

Officials are asking everyone to participate in making the event safe and enjoyable by being aware of their surroundings during their visit to a PGA TOUR event. Should a person see an activity that might be unusual or suspicious, they're urged to notify security personnel or Tournament Official working the event.

Everyone is urged to keep a simple phrase in mind: "See something, say something."

Since the safety and well-being of everyone is of the utmost importance, please adhere to standard tournament policies. Listed below is the outline of the policies and procedures that will be enforced at the Travelers Championship.

## Bag Inspection

All items are subject to search. Item inspection will be performed at all Admission Gates while gates are open.

The following bags are **PERMITTED** on tournament grounds:

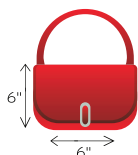

Opaque Bags  
Not to Exceed 6" x 6" x 6"  
(In their natural state)



1-Gallon Clear,  
Resealable Plastic Bag

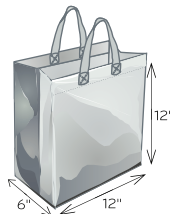

Clear Tote Bags, Plastic,  
Vinyl or Other Carry Items  
Not to Exceed 12" x 6" x 12"  
(In their natural state)



Medically Necessary  
and Infant Diaper Bags



# A-Z INFORMATION

## Prohibited Items

The following items are **PROHIBITED** at the Travelers Championship and must be returned to your vehicle:



Backpacks



Beverages or Coolers of Any Kind



Binocular Case



Cameras (Thurs - Sun)  
& Lens Larger than 6"  
(Wednesday)



Camera Bags



Chair Bags



Clear Backpack



Clear Tote Bags, Plastic,  
Vinyl or Other Carry Items  
Larger than 12" x 6" x 12"  
(In their natural state)



Computers or Laptops



Drones, Remote-Controlled  
Model Aircrafts or other  
devices that can be  
operated in airspace



Fireworks, Laser Pointers  
or Other Explosives



Knives, Firearms or  
Weapons of Any Kind



Lounge or Over-sized  
Chairs with Extended  
Foot Rests



Memorabilia including Pin  
Flags, Photos, Trading  
Cards, Balls and Other  
Sports Paraphernalia



Mesh Synch Bag



Motorcycles, Mopeds,  
Tricycles, Bicycles,  
Skateboards or  
Hoverboards



Opaque Bags  
Larger than 6" x 6" x 6"  
(In their natural state)



Outside Food or  
Beverage (Except for  
Medical or Infant Needs)



Pets (with the exception  
of Service Animals)



Plastic, Metal or Glass  
Cups, Cans or Containers



Posters, Signs,  
Banners or Ladders



Printed Pattern  
Plastic Bag



Radios, TV's, or Other  
Electronic Noise  
Producing Items



Seat Cushions  
with Carrying Case  
or Pockets



Selfie Sticks and  
GoPoles



Tinted Plastic Bag



Video Cameras



Whistles, Horns or  
Noise Makers

## Other prohibited items include:

Any other illegal substances or items deemed unlawful or dangerous by the PGA TOUR/Tournament Security Officials.

# A-Z INFORMATION

An exception will be made for fans needing to bring medical supplies into the tournament. These medically necessary items will be permitted after proper inspection at one of the admission gates.

## Permitted Items

The following items **will be** allowed at the tournament:

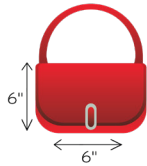

Opaque Bags  
Not to Exceed 6" x 6" x 6"  
(In their natural state)



1-Gallon Clear,  
Resealable Plastic Bag

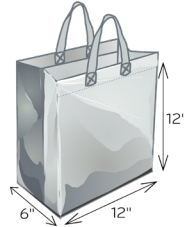

Clear Tote Bags, Plastic,  
Vinyl or Other Carry Items  
Not to Exceed 12" x 6" x 12"  
(In their natural state)



Medically Necessary  
and Infant Diaper Bags



Binoculars without  
Case



Collapsible Chair  
without Chair Bag



Mobile Phones, Tablets,  
PDA's on Silent Mode  
(Please see Mobile Device  
Policy for more information)



Infant Supplies (Infant  
must be with Carrier)



Personal transportation  
devices for mobility aid  
such as a motorized  
wheelchair or scooter



Portable Radio  
with Headset



Reusable plastic or metal  
cups/bottles **that are empty**  
**upon entry and exit** and  
cannot hold more than  
32-ounces



Seat Cushions that do not  
require a carrying case or  
that do not have pockets or  
compartments



Still Camera without Case  
& Lens Smaller than 6"  
(Wednesday)



Umbrella without Sleeve

## UNIFORM

The Travelers Championship is a televised, professional sporting event, so it is important for our volunteers to meet the standards of professional golf.

While in uniform, volunteers **must**:

- Wear the official 2023 tournament-issued **red** volunteer golf polo and hat or visor
- Wear khaki-colored pants, skirts, capris or shorts of appropriate length
- Wear closed-toe footwear that is comfortable and predominantly a neutral color (black, white or tan is preferred)
- Wear their own black rain gear, if heavy rain occurs. Red ponchos will be provided to wear over personal rain gear

While in uniform, volunteers **must not**:

- Wear denim
- Wear flip flops or sandals
- Wear branded baseball caps
- Wear metal spiked golf shoes
- Consume alcohol
- Ask for player autographs
- Smoke or vape
- Use cameras
- Use cell phones for personal use

# A-Z INFORMATION

## **VOLUNTEER AWARDS**

Hartford HealthCare is proud to honor volunteers who go above and beyond at this year's tournament. Award winners will be announced post-tournament and fellow volunteers will have the opportunity to virtually vote. Awards will be given at the Volunteer Party on September 14, 2023 at TPC River Highlands in the Clubhouse.

This year's Volunteer Awards include:

### **VOLUNTEER OF THE YEAR**

Throughout the week, committee chairs will recognize the efforts of individuals who exemplify the spirit of the Travelers Championship. Each volunteer recognized will be in the running for the Travelers Championship Volunteer of the Year award. For the winner, Hartford HealthCare will sponsor a \$2,000 donation to the winner's charity of choice.

### **ROOKIE OF THE YEAR**

This award is presented to a new volunteer who embraces their role and dives in headfirst! This volunteer's eagerness and enthusiasm is evident in all of the tasks that they take on. Being a newcomer does not stop them from performing with passion.

### **MOST CHARISMATIC**

This award is given to an individual whose enthusiasm is contagious. Their dynamic drive rubs off on their team members and contributes to the committee's overall success. Their charming spirit is noticed by whomever they are helping – a fan, player or another committee member.

### **BEST TEAM PLAYER**

It's not always easy working on a team, but this individual contributes with ease. They work well with other volunteers using a range of different skills and abilities to create positive outcome and team morale. This individual is motivating, respectful and a huge support to other volunteers. Most importantly, they always put their team ahead of themselves.

### **EXECUTIVE COMMITTEE MEMBER OF THE YEAR**

We cannot even begin to thank all of our Executive Committee members because without their year-round dedication, we would not be the tournament that we are. This award will be presented to the Executive Committee member whose commitment to the tournament has really shined this year.

## **VOLUNTEER LOUNGE IN THE FAN ZONE**

In addition to the Volunteer Villa located in the Volunteer Headquarters, the Volunteer Lounge in the Fan Zone can be utilized as a space for volunteers to take breaks or enjoy lunch. This year Hartford HealthCare provided upgrades for a larger space that includes more seating and additional comfortable seating. Snacks and water can also be found in the Volunteer Lounge.



# A-Z INFORMATION



## **VOLUNTEER PARTY**

The Travelers Championship is proud to partner with Hartford HealthCare to host the Volunteer Appreciation Party! More party details to come post-tournament.

## **VOLUNTEER APPRECIATION PARTY MARK YOUR CALENDARS FOR AN END-OF-SUMMER PARTY THURSDAY, SEPTEMBER 14 TPC RIVER HIGHLANDS | CLUBHOUSE**

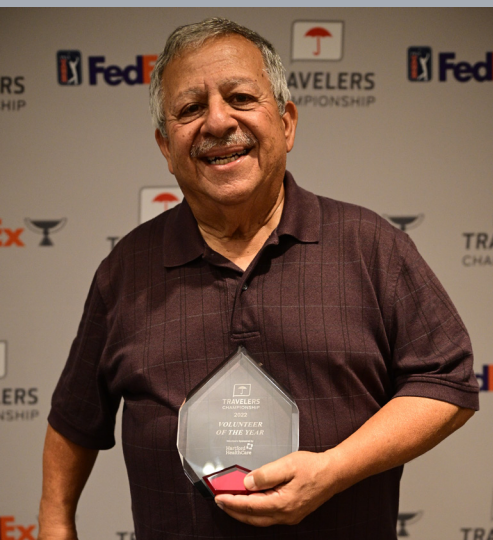

## **2022 VOLUNTEER OF THE YEAR**

### **Rosario "Riz" Rizzo**

Hole 18 Volunteer for more than 50 years!

As the Volunteer of the Year, Riz was able to make a \$2,000 donation, sponsored by Hartford HealthCare, to his charities of choice, Middlesex United Way and Community Foundation of Middlesex County

# A-Z INFORMATION

## VOLUNTEER SHUTTLE PROGRAM

Thanks to Hartford HealthCare, the tournament will be providing a NEW Volunteer Shuttle this year. The volunteer shuttle will give volunteers that have duties further out on-course an easy and convenient way to get to their assigned locations. The shuttle will run out of the Volunteer Headquarters each morning and will drop-off at the end of each day back at the Volunteer Headquarters. Please be considerate that the shuttle will not be able to provide rides to the parking lot. Below are the general volunteer shuttle stops:

- Volunteer Headquarters
- 17 Green
- 18 Green
- Hole 12
- Hole 5

## THANK YOU HARTFORD HEALTHCARE



The Travelers Championship would like to thank Hartford HealthCare for sponsoring the 2023 Volunteer Program. Each year, Hartford HealthCare is actively involved in helping the tournament enhance the volunteer experience throughout tournament week. In 2022 thanks to Hartford HealthCare, the tournament was able to provide an upgraded Volunteer Headquarters and Volunteer Villa experience. This year, with their help, volunteers will have an exclusive Volunteer Shuttle Program and an upgraded Volunteer Lounge in the Fan Zone.



# A-Z INFORMATION

## WEATHER ALERT SCALE

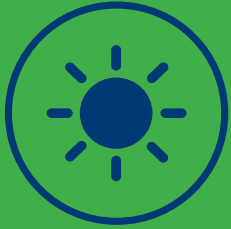

### **WEATHER POLICY**

#### **WEATHER POLICY IN EFFECT**

OBSERVE ON-COURSE SCOREBOARDS FOR WEATHER UPDATES



### **BE AWARE**

#### **INCLEMENT WEATHER POSSIBLE**

OBSERVE ON-COURSE SCOREBOARDS FOR FURTHER UPDATES



### **BE PREPARED**

#### **INCLEMENT WEATHER APPROACHING**

PREPARE TO TAKE SHELTER OR EXIT THE PREMISES

OBSERVE ON-COURSE SCOREBOARDS FOR FURTHER UPDATES

THE SAFEST PLACE MAY BE YOUR CAR



### **TAKE ACTION**

#### **INCLEMENT WEATHER**

PLAY SUSPENDED. SEEK SAFE SHELTER IMMEDIATELY OR EXIT THE PREMISES

THE SAFEST PLACE MAY BE YOUR CAR



### **COURSE CLOSED**

PLAY SUSPENDED FOR THE DAY. EXIT GRANDSTANDS,

TEMPORARY STRUCTURES, AND EXIT THE PREMISES

THE SAFEST PLACE MAY BE YOUR CAR

# MAPS & HOSPITALITY INFORMATION



- 1. Volunteers
- 2. The Hole in the Wall Gang Camp
- 3. Birdies for Charity
- 4. Mini Golf Course
- 5. Rockwall
- 6. Mohegan Sun
- 7. Xfinity
- 8. Fan Zone North Concessions
- 9. Stanley Black & Decker Chill Zone
- 10. Truly Bar
- 11. Fan Zone South Concessions
- 12. Trinity Health Of New England *(including Family Care Amenities)*
- 13. Titleist/GOLFTEC Performance Center by Charles Schwab
- 14. General Dynamics Electric Boat
- 15. PGA TOUR Training Presented by NOBULL
- 16. TRUEFORM
- 17. DraftKings
- 18. Fever-Tree Bar
- 19. Medical
- 20. Travelers Chipping Challenge and Activation

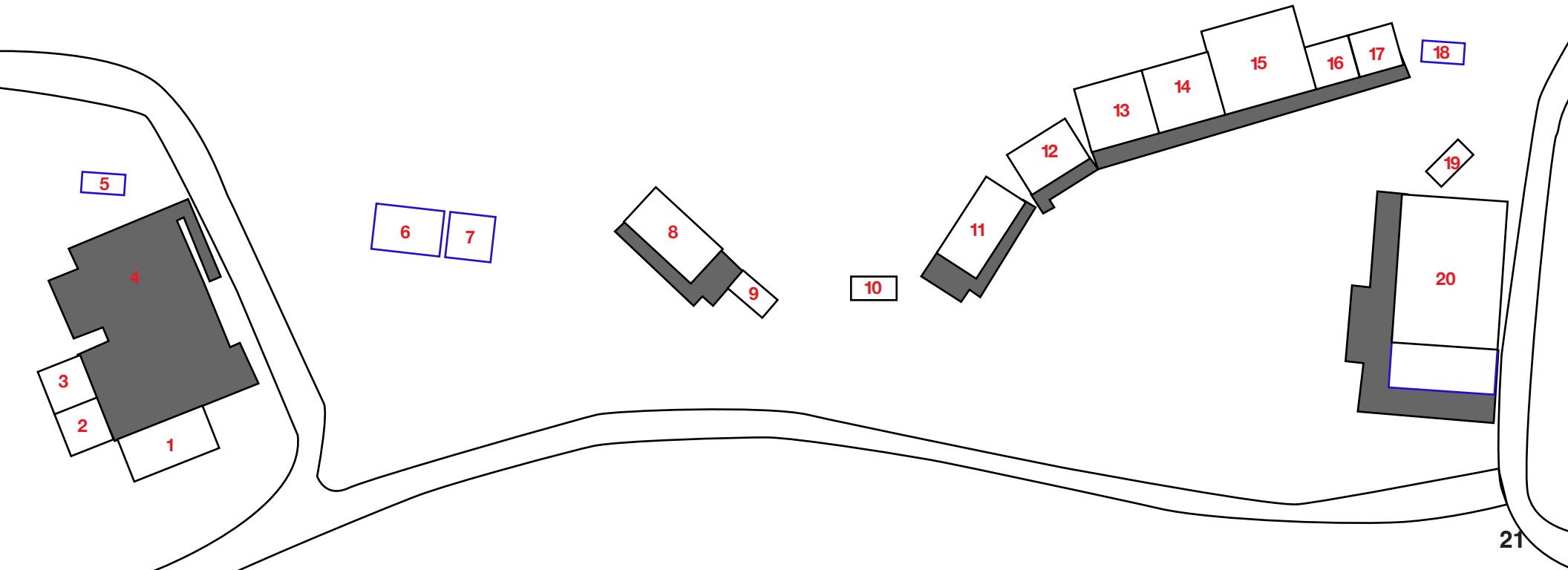

# 18<sup>TH</sup> HOLE HOSPITALITY

## Daily Skyboxes

	Wednesday	Thursday	Friday	Saturday	Sunday
12	AssetMark	Atlantic Community Bankers Bank	McCarter & English, LLP	EMCOR Services New England Mechanical	RICOH USA, INC
13	Qualtrics	Delta Dental	Virtus Investment Partners	Newline Interactive	Chris Cote's Golf Shop
14	Guidewire Software Inc	Windsor Federal	NBT Bank	Sherpa	Centurion Wealth Management
15	MahoneySabol	Transamerica	Valley Communications Systems, Inc	ReFocus Eye Health	OpenText Cybersecurity
16		KeyBank	Gordon Rees Scully Mansukhani	New England Capital Financial Advisors, LLC	DeVivo Companies
17		Torco	Torco	Marcum LLP	ReFocus Eye Health
18		Nomura Securities International	Grant Thornton	Fidelity Investments	Infinidat
19		Anthem Blue Cross and Blue Shield	Cross Insurance	Dell Technologies & Intel	
20		Litchfield Cavo LLP	MJP Wealth Advisors		Belfonti Companies, LLC
21		EchoStor Technologies	SERVPRO		Darktrace
22		Van Dyk Recycling Solutions	Middlesex Health		LAZ Parking
23		Optum	KPMG LLP	UBEO Business Services	LAZ Parking

### 1. Travelers Corporate Chalet Suite on 18

- Trinity Health Of New England
- Webster Bank
- Robinson & Cole LLP
- FORTINET
- Connecticut

### 7. Champions Club presented by Omni Hotels & Resorts

### Weekly Skyboxes on 18 Fairway

- Deloitte
- Global Atlantic Financial Company
- Accenture
- J.P. Morgan Private Bank

### 24. Golf Channel

### 25. TPC Member Skybox

### 26. Stanley Black & Decker Lounge

### 27. CVS Health® Greenside Club

### 28. Travelers Trophy Suite

### 29. Travelers Our Suite

### CVS Health® Greenside Club Clients

- |  |                             |
|--|-----------------------------|
| Anthem Blue Cross and Blue Shield      | Haboo Industries            |
| Aramark Corporation                    | Hearst CT Media Group       |
| Barkshire Bank                         | Hirckley Allan              |
| CBRE                                   | MetroHartford Alliance      |
| Charter Oak Utility Constructors, Inc. | NWN Carousel                |
| CLA                                    | Olsen Construction Services |
| Connecticut Wealth Management          | Palo Alto Networks          |
| CVS Health                             | Ring's End                  |
| East Coast Metal Roofing               | SERVPRO                     |
| Enlyte                                 | Stanley Black & Decker      |
| F3 Technology Partners                 | U.S. Bank                   |
| Fluoropolymer Resources LLC            | Westfield Bank              |
| Garity Asphalt Reclaiming              | WNS Global Services         |
| Granite City Electric                  | World Wide Technology       |
| GreatBlue Research, Inc.               | Xfinity                     |

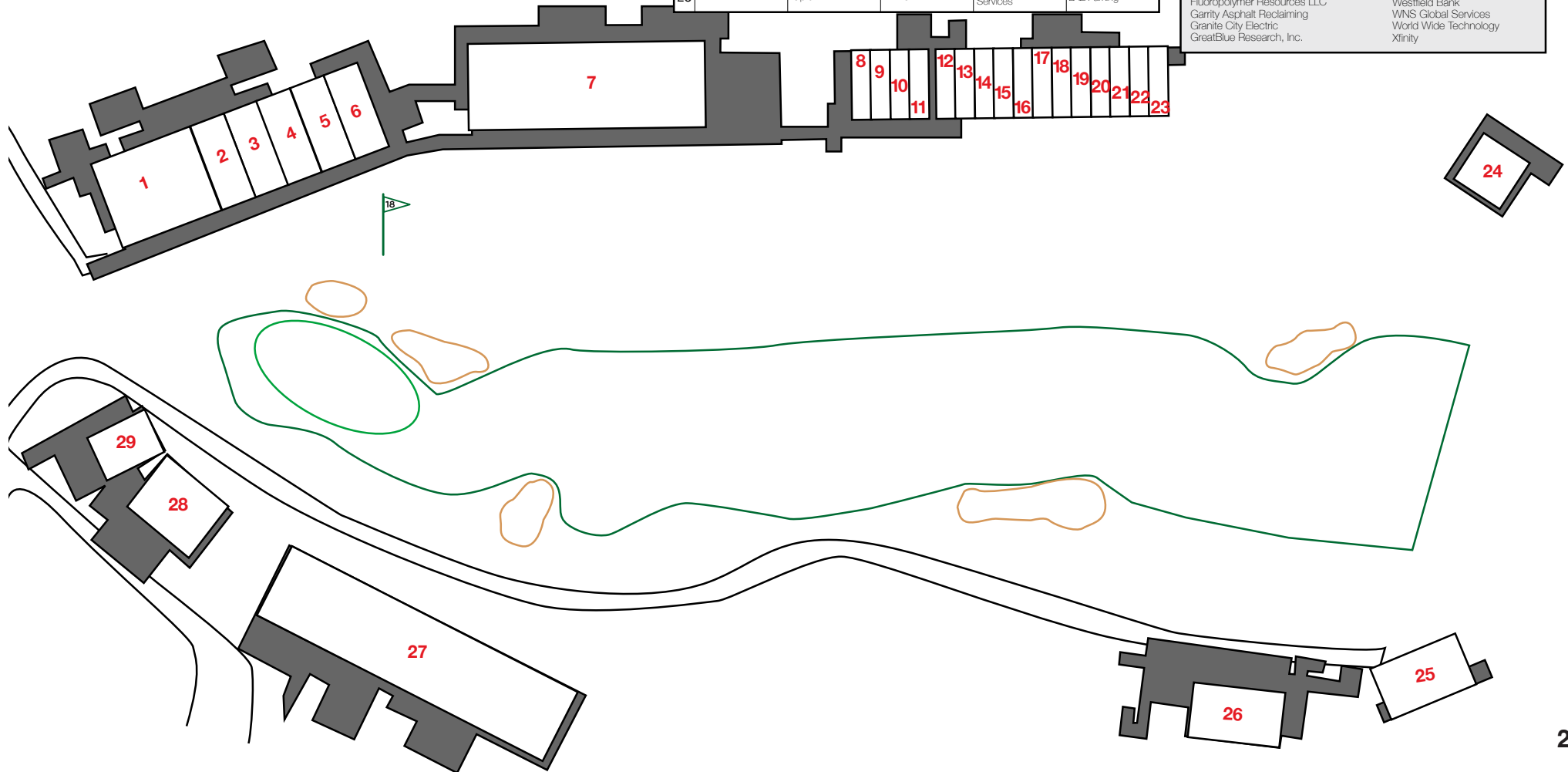

# 17<sup>TH</sup> HOLE HOSPITALITY

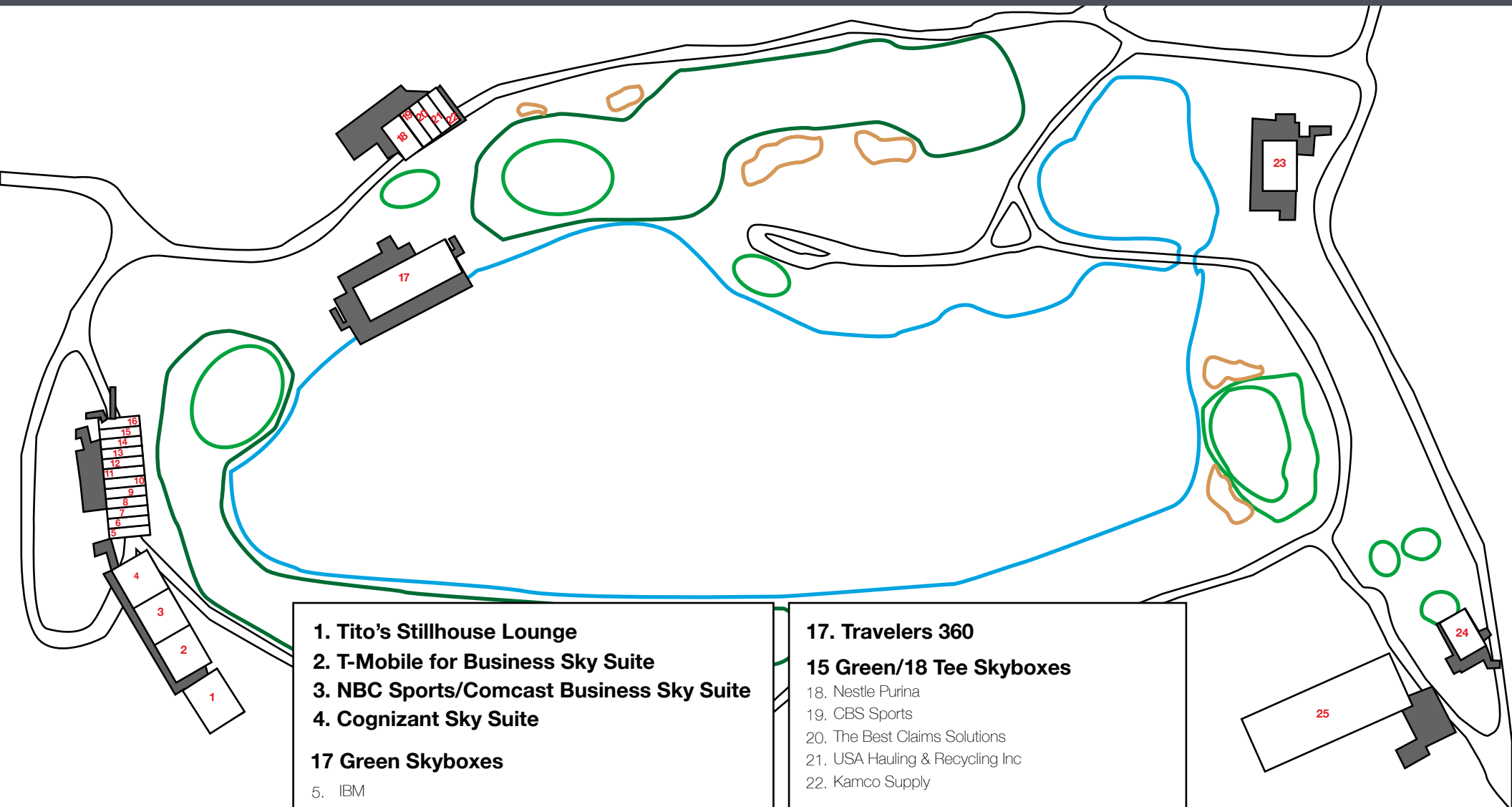

- 1. Tito's Stillhouse Lounge**
- 2. T-Mobile for Business Sky Suite**
- 3. NBC Sports/Comcast Business Sky Suite**
- 4. Cognizant Sky Suite**
  
- 17 Green Skyboxes**
- 5. IBM
- 6. Eversource
- 7. Kelsner Corporation & Hybrid Pathways
- 8. ESPN
- 9. LTIMindtree Limited
- 10. iHeartMedia
- 11. CDW
- 12. ServiceMaster Restore
- 13. CNG/SCG/UI Part of the AVANGRID Family
- 14. Dell Technologies
- 15. WFSB
- 16. Bank of America

- 17. Travelers 360**
- 15 Green/18 Tee Skyboxes**
- 18. Nestle Purina
- 19. CBS Sports
- 20. The Best Claims Solutions
- 21. USA Hauling & Recycling Inc
- 22. Kamco Supply
  
- 23. Hartford HealthCare Sports Zone**
- 24. ebm-pabst, Inc Skybox**
- 25. Mohegan Sun Club**

# A-Z HOSPITALITY CLIENTS

CLIENT	LOCATION	CLIENT	LOCATION
Accenture	18W	McCarter & English, LLP	18D
Anthem Blue Cross and Blue Shield	18D	MetroHartford Alliance	GC
Anthem Blue Cross and Blue Shield	GC	Middlesex Health	18D
Aramark Corporation	GC	MJP Wealth Advisors	18D
Arena Aztec Shaffer	GC	Mohegan Sun Club	MC
AssetMark	18D	NBC Sports/Comcast Business Sky Suite	2
Atlantic Community Bankers Bank	18D	NBT Bank	18D
Bank of America	17G	Nestle Purina	15
Belfonti Companies, LLC	18D	New England Capital Financial Advisors	18D
Berkshire Bank	GC	Newline Interactive	18D
CBRE	GC	Nomura Securities International	18D
CBS Sports	15	NWN Carousel	GC
CDW	17G	Olsen Construction Services	GC
Centurion Wealth Management	18D	OpenText Cybersecurity	18D
Champions Club		Optum	18D
presented by Omni Hotels & Resorts	CC	Palo Alto Networks	GC
Charter Oak Utility Constructors, Inc.	GC	Qualtrics	18D
Chris Cote's Golf Shop	18D	ReFocus Eye Health	18D
CLA	GC	RICOH USA, INC	18D
CNG/SCG/UI Part of the AVANGRID Family	17G	Ring's End	GC
Cognizant Sky Suite	1	Robinson & Cole LLP	S
Connecticut	S	ServiceMaster Restore	17G
Connecticut Wealth Management	GC	SERVPRO	18D
Cross Insurance	18D	SERVPRO	GC
CVS Health	GC	Sherpa	18D
Darktrace	18D	Stanley Black & Decker	GC
Dell Technologies	17G	T-Mobile for Business Sky Suite	3
Dell Technologies & Intel	18D	The Best Claims Solutions	15
Deloitte	18W	Tito's Stillhouse Lounge	SL
Delta Dental	18D	Torrco	18D
DeVivo Companies	18D	TPC River Highlands Member Skybox	RH
East Coast Metal Roofing	GC	Transamerica	18D
ebm-papst, Inc	17T	Travelers 360	T
EchoStor Technologies	18D	Travelers Corporate Chalet	TC
EMCOR Services New England Mechanical	18D	Travelers Trophy Suite	TS
Enlyte	GC	Trinity Health Of New England	S
ESPN	17G	U.S. Bank	GC
Eversource	17G	UBEO Business Services	18D
F3 Technology Partners	GC	USA Hauling & Recycling Inc	15
Fidelity Investments	18D	Valley Communications Systems, Inc	18D
Fluoropolymer Resources LLC	GC	Van Dyk Recycling Solutions	18D
FORTINET	S	Virtus Investment Partners	18D
Garrity Asphalt Reclaiming	GC	Webster Bank	S
Global Atlantic Financial Company	18W	Westfield Bank	GC
Gordon Rees Scully Mansukhani	18D	WFSB	17G
Granite City Electric	GC	Windsor Federal	18D
Grant Thornton	18D	WNS Global Services	GC
GreatBlue Research, Inc.	GC	World Wide Technology	GC
Guidewire Software Inc	18D	Xfinity	GC
Habco Industries	GC		
Hearst CT Media Group	GC		
Hinckley Allen	GC		
IBM	17G		
iHeartMedia	17G		
Infinidat	18D		
J.P. Morgan Private Bank	18W		
Kamco Supply	15		
Kelser Corporation & Hybrid Pathways	17G		
KeyBank	18D		
KPMG LLP	18D		
LAZ Parking	18D		
Litchfield Cavo LLP	18D		
LTIMindtree Limited	17G		
MahoneySabol	18D		
Marcum LLP	18D		

VENUE	KEY
15 Green Weekly Skyboxes	15
17 Green Weekly Skyboxes	17G
17 Green Sky Suites	1, 2, 3
17 Tee Weekly Skybox	17T
18 Fairway Daily Skyboxes	18D
18 Fairway Weekly Skyboxes	18W
Champions Club	
presented by Omni Hotels & Resorts	CC
CVS Health® Greenside Club	GC
Mohegan Sun Club	MC
Suite on 18	S



June 19-25, 2023  
TPC River Highlands | Cromwell, CT



**Stanley Black & Decker Fan Zone**

Icons: Concessions, Drink Stand, Medical, Mini Golf Course, Restrooms, Special Assistance Shuttle

**Event Lawn**

Icons: BP, Concessions, Drink Stand, Question Mark, HO, Restrooms

Gold Lot  
(General Parking)

**Main Gate**

Icons: ADA Shuttle, Signage, Restrooms

**9 Green**

Icons: C, Signage, O, Question Mark

**Practice Facility**

Icons: Concessions, Drink Stand, Question Mark, T-shirt, RD, Restrooms

PRIVATE VENUES	
<b>CC</b> Champions Club presented by <b>OMNI</b> HOTELS & RESORTS	<b>SS</b> Sky Suites
<b>GC</b> CVS Health® Greenside Club	<b>SB</b> Skyboxes <small>15 Green, 17 Tee, 17 Green, 18 Fairway</small>
<b>CL</b> Clubhouse	<b>S</b> The Suite on 18
<b>HO</b> Honorary Observer Check-In	<b>RH</b> TPC Member Skybox
<b>MC</b> <i>Mahogan Sun</i> Club	<b>T</b> Travelers 360
<b>M</b> Media Center	<b>TC</b> Travelers Corporate Chalet
<b>PA</b> Pro-Am Tent	<b>TS</b> Travelers Trophy Suite
	<b>V</b> Hartford HealthCare Volunteer Headquarters

OPEN TO ALL FANS	
<b>C</b> CASAMIGOS <i>Trips</i> House of Friends	<b>BP</b> COMCAST BUSINESS Pavilion <small>Hospitality Ticket Required</small>
<b>SZ</b> Hartford HealthCare Sports Zone	<b>PO</b> Patriots' Outpost presented by Trinity Health of New England <small>Military Service Members and U.S. Veterans</small>
<b>L</b> StanleyBlack&Decker Lounge	<b>SL</b> Tito's STILLHOUSE

AMENITIES & EXPERIENCES	
<b>B</b> Bleacher Seating*	<b>X</b> Mini Golf Course
<b>+</b> Concessions	<b>♿</b> Off-Site ADA Shuttle Drop-Off/Pick-Up
<b>🚗</b> Rideshare Drop-Off/Pick-Up	<b>A</b> ProHealth Adirondack Seating
<b>🍹</b> Drink Stand	<b>RD</b> Radio Deck
<b>?</b> Fan Services presented by SEABOURN	<b>♿</b> Restrooms**
<b>🛍</b> Fan Shop	<b>O</b> SEABOURN Observation Deck
<b>🪑</b> Chair Rentals	<b>S</b> Special Assistance Shuttle
<b>+</b> Medical provided by Saint Francis Hospital	<b>🟡</b> StanleyBlack&Decker Fan Zone
	<b>♿</b> Trinity Health Family Care Amenities

\* ADA viewing locations can be found at holes 9 & 18, as well as all bleacher locations  
 \*\* Each location includes a handicap accessible restroom  
 A dashed red line denotes pedestrian crosswalks



# **TRAVELERS**

## **CHAMPIONSHIP**

---

[www.TravelersChampionship.com](http://www.TravelersChampionship.com)  
[#TravelersChamp](https://twitter.com/TravelersChamp)

## **HOW CAN WE HELP?**

**Text issue and location to**  
**860-86(4-HELP)**  
**(860-864-4357)**

---

## **THANK YOU**

Volunteers Sponsored by

Hartford   
HealthCare

The logo for Hartford HealthCare features a stylized 'H' composed of four curved segments in blue, green, purple, and orange.