



TRAVELERS CHAMPIONSHIP



VOLUNTEER HANDBOOK



FedEx Cup

JUNE 18-24, 2018
TPC RIVER HIGHLANDS
CROMWELL, CT

HOW CAN WE HELP?

The tournament has implemented a text communications system that can be used for guest services and operational issues. Signage will be located around the course with this information.

Text “BIRDIE” <space> issue and location to 69050

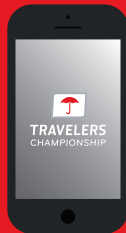

Below are a few examples of when to use the texting system:

- Bathroom Maintenance
- Tripping Hazards
- Lost and Found Items
- Disruptive Guests



A Win to Remember.....	2
2018 Executive Committee.....	3
Volunteer Information.....	4
Badges.....	5
Emergencies.....	5
Food & Beverage.....	5
Golf Carts.....	6
Golf Etiquette.....	6
Helpful Hints.....	6
Important Contact Numbers.....	6
Merchandise Promotion.....	7
Parking.....	7
Personal Belongings.....	7
Uniform.....	8
Volunteer Appreciation Party.....	9
Volunteer Recognition.....	10
General A-Z Information.....	12
ADA Parking.....	13
ADA Viewing Locations.....	13
ATMs.....	13
Ambassador Locations.....	13
Autographs.....	13
Bleachers.....	13
Charitable Impact.....	13
Concession Stands & Locations.....	14
Family Care Station.....	15
Hospitality Locations & Hours.....	15
Lost and Found.....	16
Medical.....	16
Merchandise Tent/Fan Shop.....	17
Metal Detection.....	17
Metal Spike Policy.....	17
Military Appreciation.....	17
Mobile Device Policy.....	17
Mobility Impaired Spectators.....	18
Public Restrooms.....	18
Safety.....	18
Special Events.....	18
Security Policy.....	21
Special Assistance Shuttle.....	23
Texting Program (How Can We Help?).....	23
Ticket Programs.....	23
Weather.....	24
Will Call.....	24
Maps & Hospitality Information.....	25
Notes.....	36

A WIN TO REMEMBER

Making his Travelers Championship debut, Jordan Spieth opened the tournament in style, firing a 63 to grab the lead. Spieth held the outright lead after each of the first three rounds (63-69-66), but was caught on Sunday when Daniel Berger pulled even with two late birdies on the back nine. Both players made up-and-down par saves from the greenside bunker on the 72nd hole to stay at 12-under. For the fifth time since 2007, when Travelers became title sponsor, the Travelers Championship would go into a playoff. On the first extra hole, Spieth's drive clipped a tree but the ball bounced into the fairway, while Berger drove into the left rough. Spieth's approach would land in the same greenside bunker as earlier. Faced with a 20-yard bunker shot, Spieth would claim the Travelers Championship with one unforgettable swing. He holed out from the bunker for birdie, and followed with one of the best celebrations in Travelers Championship history, joyously tossing his club and jumping up and chest bumping caddie Michael Greller. Berger's birdie putt to tie slid past the hole, giving Jordan Spieth his 10th PGA TOUR victory before the age of 24, this one in wire-to-wire fashion.



2018 EXECUTIVE COMMITTEE & ASSISTANTS

ADMINISTRATION

Meagan Mirkovich
Asst: Kristin Wirtanen

AIRPORT CONCIERGE

James Anderson
Asst: Jennifer Bouquot

AMATEUR CADDIES

Marc Zirolli
Asst: Steve Zirolli

AMBASSADORS

Shawn Daly
Asst: Monica Zapata

CORPORATE HOSPITALITY

Art Kuever
Asst: Richard Sinclair
Asst: Richard Steere

DELIVERIES

Steve Dahlem
Sam Marteka

DISTRIBUTION

Ben Troup
Ray Shaw

FAN VENUES

Bob Cattel
Asst: Lucian Terranova
Asst: Mark Vining

FAN ZONE

Jennifer Shea
Asst: Andy Farber
Asst: Ellen Farber

GALLERY

Maureen O'Connor
Asst: Diane Fuore
Asst: Karen Orton
Mobile Asst: Greg Hammond

GATES

Karissa Steltzer
Asst: Sam Guerra

MEDIA

John Mayo

MILITARY APPRECIATION

Sharon O'Brien
Chris Ward

PLAYER LOGISTICS

Michelle Clark
Jay Dykstra
Asst: Richard Laury

PLAYER RELATIONS

Drew Gallup
Asst: David May

PLAYER TRANSPORTATION

Dawn Kirkwood
Donna Thomas

PRACTICE FACILITY

Jay Salvador
Asst: Joe Milositz
Asst: Alice Shea

PRO-AM

Mike Maksymiw
Asst: Thomas Kim

PRO CADDIE HOSPITALITY

Maggie Pastore
David Timm

SCORING

Nick Giuliano
Laser Operators: Woody Mrozowski
Standard Bearers: Jeffrey Levine
Walking Scorers: Charles "Buddy" Buder
Walking Scorers: Brian Zimmerli

SKYBOXES

Dana Shults
Danielle Sobocinski

SPONSOR VALET

Bryan Fix
Anne Martin

STARTERS

John Shulansky

VOLUNTEER SERVICES

Rick Buckley
Pam House

VOLUNTEER VILLA

Mimi Reyes
Asst: Adam Famiglietti
Asst: Karen Ford

WILL CALL

Larry Wilder
Asst: Lisa Wilson



TRAVELERS CHAMPIONSHIP



VOLUNTEER INFORMATION

VOLUNTEER INFORMATION

BADGES

VOLUNTEER BADGE – BLUE

This blue badge is given to each volunteer and allows “grounds only access” to the event all week. Volunteers must keep this badge visible at all times and may use this badge as a ticket to the event on days that they are not volunteering. Please do not wear your volunteer uniform on days that you are not volunteering.

MARSHAL & SCORING BADGES – ORANGE

These orange badges are given to all hole marshal and scoring volunteers and allows “grounds only access” to the event all week. The hole marshal and scoring badges allow for these volunteers to go “inside the ropes” along the 18 holes. All volunteers must keep this badge visible at all times and may use this badge as a ticket to the event on days that they are not volunteering. Please do not wear your volunteer uniform on days that you are not volunteering.

GROUND'S BADGE – BLACK

Each volunteer is given a grounds badge to distribute to a guest and use as a ticket to the event all week. The grounds badge gives the guest “grounds access only.”

EMERGENCIES

If an emergency occurs, please dial 911 and notify the committee chair, a hole captain or staff member closest to you. They will radio the nearest Saint Francis Hospital and Medical Center medical personnel.

FOOD & BEVERAGE

BREAKFAST

Throughout the week, the Volunteer Villa will provide breakfast each morning for all volunteers, starting at 5:00 a.m. Please make sure you stop by the Villa to check in and enjoy our enhanced breakfast offering hot items courtesy of Hartford HealthCare, Wednesday - Sunday.

LUNCH

Volunteers must pick up their volunteer meal vouchers each morning in the Volunteer Villa unless told otherwise by their chair. Please remember that the meal vouchers are day specific and cannot be redeemed for alcohol or apparel. Food vouchers will be preloaded with \$17. Once used, vouchers will have a declining balance. These food vouchers will be accepted at designated concession areas on course including Bear's Smokehouse BBQ, Ben & Jerry's Scoop Shops (not carts) and Dunkin' Donuts.

AFTERNOON SNACK

Throughout the week, the Volunteer Villa will provide snacks for the volunteers to take out on the course. Volunteers should stop by the Villa to take a break and grab an afternoon snack.



VOLUNTEER INFORMATION

GOLF CARTS

Any volunteer using a cart should use caution as to not interfere with play in any manner. Always operate with caution! Watching play while on a golf cart is strictly prohibited. Please follow all cart enforcements and policies throughout tournament week.

All volunteers operating a golf cart must be at least 18 years old, have watched the video and signed the golf cart waiver.

GOLF ETIQUETTE

- Please be quiet when marshals raise their hands prior to any shot.
- Please wait for the marshal's signal before crossing any fairways.
- Please refrain from moving or walking when a player is preparing to hit a shot.
- Please respect the player's concentration and do not speak with them while on course.
- Unless instructed otherwise, please stay outside the ropes.

HELPFUL HINTS

- Bring bug spray and sunscreen.
- Display your credential at all times.
- Drink plenty of fluids! Bring your water bottle every day and utilize the Volunteer Villa and Volunteer Appreciation Station located in the Stanley Black & Decker Fan Zone.
- Wear your volunteer hat or visor for protection from the sun.
- Treat every guest and volunteer of the tournament with the utmost kindness and respect.
- Please be aware that every interaction you have with a player, spectator, sponsor or volunteer may make or break their experience.

IMPORTANT CONTACT NUMBERS

Tournament Office:

Phone Number: 860-502-6800

Email: info@travelerschampionship.com

Tournament Staff Contact:

Taylor Whiting, Volunteer and Charity Coordinator

Phone Number: 860-502-6819

Email: volunteers@travelerschampionship.com

VOLUNTEER INFORMATION

MERCHANDISE PROMOTION FOR ALL VOLUNTEERS!

All volunteers will receive a 20% discount in the tournament merchandise tent during normal business hours (Wednesday – Sunday).

To receive the discount, you must present your volunteer badge upon purchasing your items.

PARKING

All volunteers are given a pass to park in Lot B in the Gold Lot. Volunteers will then proceed to the Volunteer Villa where they will check in for their scheduled shift. Please remember that it will take approximately 25 minutes from the time you park until the time you arrive at your scheduled post. Please account for high traffic at the parking lot entrance. Please plan ahead to allot enough time to arrive for your shift on time. Volunteers who arrive without their tournament-issued parking pass will be charged the \$15.00 parking fee.

PERSONAL BELONGINGS

Unfortunately, there are no locations for volunteers to store their personal belongings. We recommend that anything of value be left at home. Volunteers are allowed to bring in a bag that complies with our updated security policy. Please see page 21 for the full policy.

VOLUNTEER INFORMATION



UNIFORM

The Travelers Championship is a televised, professional sporting event, so it is important for our volunteers to meet the standards of professional golf.

While in uniform, volunteers **must**:

- Wear the official 2018 tournament-issued **red** volunteer golf polo and hat or visor
- Wear khaki-colored pants, skirts, capris or shorts of appropriate length
- Wear closed-toe footwear that is comfortable and predominantly a neutral color (black, white or tan is preferred)
- Wear their own black rain gear, if heavy rain occurs. Red ponchos will be provided to wear over personal rain gear
- Treat every guest and volunteer of the tournament with the utmost respect

While in uniform, volunteers **must not**:

- Wear the previous year's golf polos, hats or visors
- Wear denim
- Wear flip flops or sandals
- Wear branded baseball caps
- Consume alcohol (except at the Volunteer Appreciation Party)
- Ask for player autographs
- Participate in fan activities
- Smoke or vape
- Use cameras
- Use cell phones for personal use

VOLUNTEER INFORMATION

VOLUNTEER APPRECIATION PARTY

The Travelers Championship is proud to partner with Hartford HealthCare to host a Volunteer Appreciation Party. Come join us for a fun night with your fellow volunteers, featuring Bear's Smokehouse BBQ, as we thank our volunteers and celebrate the 2018 Travelers Championship!

The 2018 Volunteer of the Year and other volunteer recognition awards will be presented at the party.

All volunteers must present their volunteer badge in order to attend the party. Unfortunately, guests are not permitted to attend.



SATURDAY, JUNE 23

5:00 P.M. - 8:30 P.M.

PRO-AM TENT

Hartford
HealthCare
Connect to healthier.™

BBO
BEAR'S
SMOKEHOUSE

2017 VOLUNTEER OF THE YEAR

Ira Jones, Player Transportation

As the Volunteer of the Year, Ira was able to make a \$2,000 donation, sponsored by Hartford HealthCare, to his charity of choice, Susan G. Komen New England!



VOLUNTEER RECOGNITION

To recognize the extraordinary efforts of the Travelers Championship volunteers, Hartford HealthCare would like to honor volunteers who go above and beyond as the 2018 Volunteer of the Year, Volunteer Executive Committee Volunteer of the Year, and other volunteer recognitions as voted on by the volunteers. Below is a list of the awards to be presented in 2018. Stop by the Villa to vote for your fellow volunteers.

VOLUNTEER OF THE YEAR

Throughout the week, the committee chairs will recognize the efforts of individuals and groups who exemplify the spirit of the Travelers Championship. Each volunteer recognized will be in the running for one of the 2018 Travelers Championship volunteer awards. For the 2018 Volunteer of the Year, Hartford HealthCare will sponsor a \$2,000 donation to the winner's charity of choice.

ROOKIE OF THE YEAR

This award is presented to a new volunteer who embraces their role and dives in head first! This volunteer's eagerness and enthusiasm is evident in all of the tasks that they take on. Being a newcomer does not stop them from performing with passion.

MOST CHARISMATIC

This award is given to an individual whose enthusiasm is contagious. Their dynamic drive rubs off on their team members and contributes to the committee's overall success. Their charming spirit is noticed by whomever they are helping - a fan, player or another committee member.

BEST TEAM PLAYER

It's not always easy working on a team, but this individual contributes with ease. They work well with other volunteers using a range of different skills and abilities to create positive outcomes and team morale. This individual is motivating, respectful and a huge support to other volunteers. Most importantly, they always put their team ahead of themselves.

EXECUTIVE COMMITTEE VOLUNTEER OF THE YEAR

We cannot even begin to thank all of our Executive Committee members because without their year-round dedication, we would not be the tournament that we are. This award will be presented to an Executive Committee member whose commitment to the tournament has really shined this year.

VOLUNTEER VILLA

New this year, all volunteers must proceed through the main gate and security to gain access to the Villa. Volunteers must check in at the Villa before their shift. The Villa opens at 4:30 a.m. Monday - Sunday of tournament week for registration. Breakfast is provided at 5:00 a.m.



The Travelers Championship would like to thank Hartford HealthCare for sponsoring the 2018 Volunteer Program. Each year, Hartford HealthCare is actively involved in helping the tournament enhance the volunteer experience throughout tournament week.

Again, this year, Hartford HealthCare will be providing a Volunteer Appreciation Station in the Stanley Black & Decker Fan Zone for volunteers to take a snack or fill up their complimentary Hartford HealthCare water bottle.

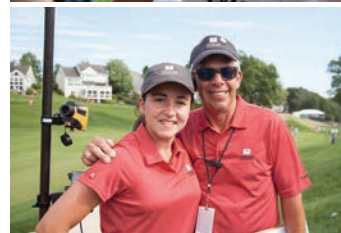



TRAVELERS CHAMPIONSHIP

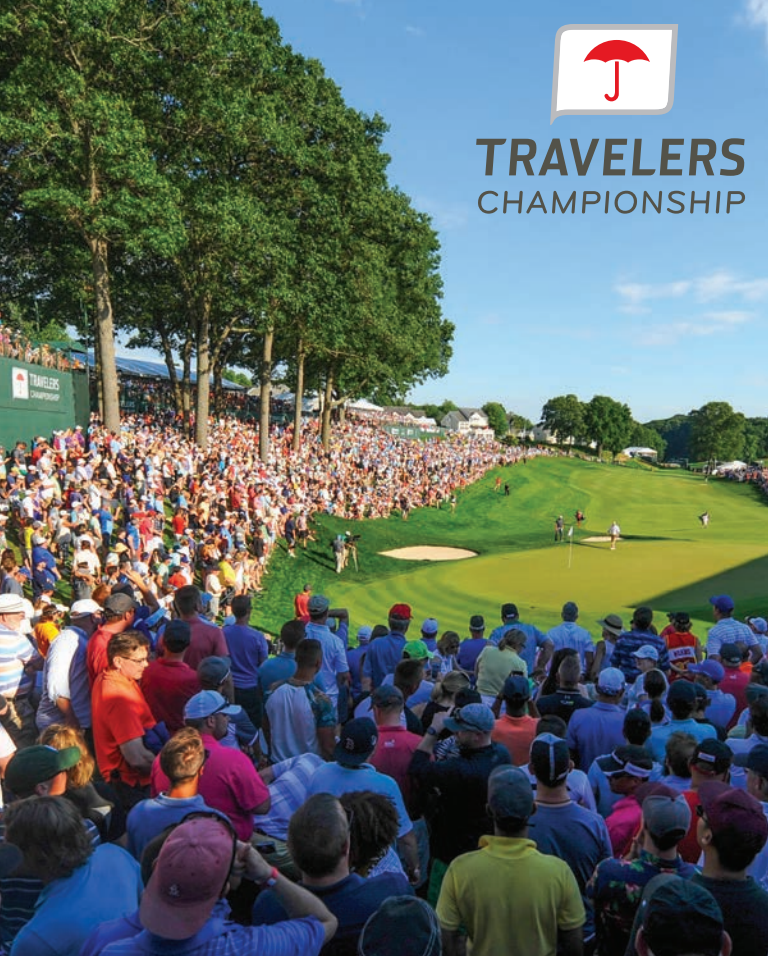

GENERAL A-Z INFORMATION

A-Z INFORMATION

ADA PARKING

Please visit our website, www.TravelersChampionship.com for more information.

ADA VIEWING LOCATIONS

1st Tee, 8th Green, 9th Green, 10th Tee, 18th Green, Practice Facility

ADMISSION GATES LOCATIONS AND HOURS

There are three admission gates to the Travelers Championship:

- Main Gate: Accessible via main entrance and Gold Lot (Lot B) Parking
- 9th Hole Fairway: Accessible via Red Lot
- 6th Hole Green: Accessible via Field Road

Gates open at 7:00 a.m. on Monday, Tuesday, Saturday and Sunday and open at 6:00 a.m. Wednesday through Friday.

ATMS

ATMs are located at the Main Entrance, Merchandise Tent, 18 Concessions, Stanley Black & Decker Fan Zone and the Mohegan Sun Sponsor Club.

AMBASSADOR LOCATIONS

There are eight ambassador locations at the Travelers Championship:

- Headquarters – 9/10 Crossover
- Main Entrance
- Clubhouse Crossover
- 18 Green
- Patriots' Outpost – 1st Tee
- 17th Green
- Fan Zone – Center
- 9th Hole Gate

AUTOGRAPHS

Autographs are permitted each day after the completion of a player's round and only after they have signed their scorecard.

BLEACHERS

Bleachers, presented by Nestlé Purina, can be found in the following locations: Practice Facility, Mini Golf Course in the Fan Zone, 1st Tee, 8th Green, 9th Green and the 10th Tee.

CHARITABLE IMPACT

The Travelers Championship is proud to be a PGA TOUR event, which donates 100 percent of net proceeds to charity every year. Since 1952, the tournament has generated more than \$38 million for charity and in 2017, the Travelers Championship generated \$1.7 million for 165 charities throughout the region.

A-Z INFORMATION

The primary beneficiary for the 2018 tournament will be The Hole in the Wall Gang Camp in Ashford, Connecticut. Founded in 1988 by Paul Newman, The Hole in the Wall Gang Camp provides “a different kind of healing” to more than 25,000 seriously ill children and family members annually – all completely free of charge. For many of these children and families, Hole in the Wall provides multiple Camp experiences throughout the year.

Each summer, The Hole in the Wall Gang Camp provides weeklong camping experiences that seamlessly incorporate round-the-clock medical care so that campers can participate in horseback riding, fishing, archery and other activities. In the process, the campers discover that they can do more than they ever thought possible while also forming friendships with other children just like them. Throughout the rest of the year, the Camp hosts family weekends, makes daily hospital outreach visits in more than 40 locations across the Northeast and delivers programming right to camper homes and hometowns.

CONCESSION STAND LOCATIONS & HOURS

Practice Facility (Breakfast Available)

10 a.m. – 5 p.m. | Monday - Tuesday
7 a.m. – 7 p.m. | Wednesday - Sunday

Hole No. 5 & Hole No. 8

10 a.m. – 6 p.m. | Wednesday - Thursday
10 a.m. – 5 p.m. | Friday
10 a.m. – 4 p.m. | Saturday - Sunday

Hole No. 9 Beverage Tent

10 a.m. – 7 p.m. | Wednesday - Sunday

Hole No. 12

10 a.m. – 7 p.m. | Wednesday - Friday
10 a.m. – 5 p.m. | Saturday - Sunday

Hole No. 15

10 a.m. – 7 p.m. | Thursday - Friday
10 a.m. – 6 p.m. | Saturday - Sunday

Hole No. 18 (Breakfast Available)

10 a.m. – 5 p.m. | Tuesday
7 a.m. – 7 p.m. | Wednesday - Sunday

A-Z INFORMATION

Fan Zone

10 a.m. – 7 p.m. | Wednesday, Thursday, Sunday
10 a.m. – 8 p.m. | Friday, Saturday

Upper 15 Beverage Stand

10 a.m. – 7 p.m. | Wednesday - Friday
10 a.m. – 6 p.m. | Saturday - Sunday

Stanley Black & Decker Lounge

10 a.m. – 7 p.m. | Wednesday – Sunday

Amstel Light Public House

10 a.m. – 7 p.m. | Wednesday – Sunday

FAMILY CARE STATION

A family care station, including a baby changing area, can be found in the Stanley Black & Decker Fan Zone.

GOLF ETIQUETTE

Please be considerate at all times of the PGA TOUR players and other spectators. This includes not making any unnecessary noise and refraining from making any movement that would disrupt play on the golf course.

HOSPITALITY LOCATIONS & HOURS OF OPERATION

Aetna Greenside Club

8:30 a.m. – 30 minutes post play
18th Green, Player Right

Aer Lingus Champions Club

10 a.m. – 30 minutes post play
18th Green, Player Left

Amstel Light Public House (*Open to the Public*)

10 a.m. – 30 minutes post play
9th Green, Player Right

Corporate Row Chalets

10 a.m. – 30 minutes post play
18th Fairway, Player Right

Hartford HealthCare Sports Zone (*Open to the Public*)

10 a.m. – 30 minutes post play
15th Tee/16th Green

Military Viewing Deck presented by Bear's Smokehouse BBQ

18th Green, Player Left
(*must be accessed through the Patriots' Outpost*)

A-Z INFORMATION

Michelob ULTRA Club (*Open to the Public*)

10 a.m. – 30 minutes post play
17th Green, Player Left

Mohegan Sun Sponsor Club

10 a.m. – 30 minutes post play
18th Fairway, Player Right

Patriots' Outpost presented by Trinity Health Of New England

10 a.m. – 30 minutes post play
Adjacent to 1st Tee

Skyboxes / Sky Suites

10 a.m. – 30 minutes post play
15th Green/18th Tee, 17th Green, 17th Tee

Stanley Black & Decker Lounge (*Open to the Public*)

10 a.m. – 30 minutes post play
18th Fairway, Player Left

TPC Member Area*

Clubhouse Patio

Travelers 360

17th Green/15th Tee

Travelers Corporate Row

18th Fairway, Player Right

Travelers Trophy Suite

18th Green, Player Left

All hospitality venues are open Wednesday – Sunday.

**Please note, the TPC Member Area is only open Thursday – Sunday*

LOST AND FOUND

Lost and Found is located at the Tournament Office near the main entrance. Call (860) 502-6800 or Text "Birdie" <space> issue and location to 69050 to report something lost or found.

MEDICAL

Medical Headquarters is located adjacent to the Clubhouse Parking Lot. Medical assistance is also available behind the 5th tee, and on the 12th and 17th holes. Medical services are provided by Saint Francis Hospital and Medical Center.

A-Z INFORMATION

MERCHANDISE TENT/FAN SHOP

Official Travelers Championship merchandise may be purchased at the Fan Shop located near the 9th Green.

METAL DETECTION

Everyone attending the tournament is subject to search at the entrances and on the course at any time.

METAL SPIKE POLICY

If you plan to wear golf shoes to the tournament, please note that TPC River Highlands has a **No Metal Spike Policy**.

MILITARY APPRECIATION

The tournament is once again proud to support U.S. Armed Forces with Military Appreciation presented by Trinity Health Of New England. This weeklong salute will give military personnel and their families a chance to see some of the best golfers compete at TPC River Highlands June 18-24, 2018. Military Service Members and their dependents will receive complimentary admission all week courtesy of Trinity Health Of New England. With the support of Bear's Smokehouse BBQ, the Travelers Championship is proud to offer complimentary admission into the tournament all week to all U.S. Veterans and their immediate family members.

MOBILE DEVICE POLICY

- Devices must be on silent at all times; flash may not be used.
- Devices may be used to capture video, audio and photos (content) in all areas throughout tournament week.
- Content may be used for personal purposes (e.g., personal social media); no commercial use.
- No live streaming or real-time coverage (e.g., no shot-by-shot coverage).
- Data use (e.g., texting) is permitted in all areas throughout tournament week.
- Phone calls are allowed only in designated areas.
- Please be respectful of play and do not interfere with players, caddies or media.
- All posted signage and instructions from tournament staff must be observed.
- Failure to comply with this policy may result in the revocation of your ticket.

A-Z INFORMATION

Please see the back of your ticket for the complete terms of the Spectator Mobile Device Policy. The ticket back language is also located here: www.pgatour.com/ticketterms

MOBILITY IMPAIRED SPECTATORS

Spectators with disabilities receive free parking, shuttle service and special seating at the tournament. The complimentary parking location will be finalized soon. This parking is for any vehicle displaying an official handicap license plate or placard.

A specially-equipped shuttle van will carry mobility-impaired spectators to and from the ADA parking lot and TPC River Highlands.

Once on-site, there are several areas where spectators will have an unobstructed view of the golf action. These areas are located at the: 1st Tee, 8th Green, 9th Green, 10th Tee, 18th Green adjacent to Champions Club and Practice Facility. Inside this area, a level area for wheelchairs will be available, as well as companion chairs.

There is also an on-site special assistance shuttle for guests to utilize. On-course Special Assistance Shuttle stops include Main Gate, 18 Concessions and 18 Fairway Crosswalk. Hours of operation are Wednesday-Sunday 7:00 a.m. to 7:00 p.m. Special Assistance Shuttle is provided by Oak Hill.

For more information, visit <http://travelerschampionship.com/ada-and-special-assistance/> or call the tournament office at (860) 502-6800.

PUBLIC RESTROOMS

Public Restrooms are located throughout the course and are marked on the course map.

SAFETY

Please be alert. Golf balls, especially on Pro-Am days, may inadvertently be hit into spectator areas.

SPECIAL EVENTS

Weeklong Activities

Military Appreciation presented by Trinity Health Of New England
Monday - Sunday | Patriots' Outpost open Wednesday - Sunday

Farmington Bank Kids Zone
Tuesday - Sunday

Stanley Black & Decker Fan Zone
Wednesday - Sunday

A-Z INFORMATION

iHeartRadio Broadcasts Live from the Big Y Radio Deck
97.9 ESPN & 1300 AM present The Rob Dibble Show
Monday - Sunday

Fairways of Life with Matt Adams
Wednesday - Friday | Clubhouse Patio

Operation Birdies presented by Kaman
Thursday - Sunday | 17th Hole

Monday, June 18

Opening Ceremony
9 a.m. | Hole No. 1

Aetna Tournament Players Pro-Am
12:30 p.m. | Shotgun Start

Tuesday, June 19

Travelers Championship Practice Round
All Day

PGA Junior League Matches
7 a.m. - 1 p.m. | Practice Facility

Operation Shower presented by ConnectiCare®
11 a.m. - 1 p.m. | The First Tee of Connecticut

Eversource PGA TOUR Player Experience for Junior Golfers
1:30 p.m. - 4:30 p.m. | Practice Facility

Wednesday, June 20

Travelers Celebrity Pro-Am
Tee Times | 6:50 a.m. - 2 p.m.

102.9 The Whale Live Broadcasts
10 a.m. - 6 p.m. | Across from the Merchandise Tent

Military Caddie Program presented by Trinity Health Of New England
8 a.m. - 2 p.m. | 17th Hole

Farmington Bank Celebrity Mini Golf Tournament
9:30 a.m. & 10:30 a.m. Shotgun Start | Farmington Bank Mini Golf Course

Off-Site Pro-Am at Wethersfield Country Club
1 p.m. | Shotgun Start

A-Z INFORMATION

WFAN presents The Boomer & Gio Show
6 a.m. - 10 a.m. | Big Y Radio Deck

Thursday, June 21

Travelers Championship First Round
7 a.m. - 2 p.m. | Tee Times

WDRG presents The Brad and Dan Show
5 a.m. - 10 a.m. | Patriots' Outpost

Women's Day presented by Travelers
8:30 a.m. - 12 p.m. | Pro-Am Tent

HYPE's Tee It Up for Charity
5:30 p.m. | Pro-Am Tent

WTIC presents Afternoons with Todd Feinburg
3 p.m. - 6 p.m. | Mohegan Sun Sponsor Club

Friday, June 22

Travelers Championship Second Round
7 a.m. - 2 p.m. | Tee Times

K9s For Warriors presented by Stryker
10:30 a.m. - 11:30 a.m. | Patriots' Outpost

Liberty Bank Concert Series featuring Survivor
Approx. 7 p.m. - 8:30 p.m. | Stanley Black & Decker Fan Zone

Saturday, June 23

Travelers Championship Third Round
8 a.m. - 2 p.m. | Tee Times

Volunteer Party sponsored by Hartford HealthCare
5 p.m. | Pro-Am Tent

Liberty Bank Concert Series featuring Tyler Farr
Approx. 7 p.m. - 8:30 p.m. | Stanley Black & Decker Fan Zone

Sunday, June 24

Travelers Championship Final Round
8 a.m. - 2 p.m. | Tee Times

Closing Ceremony
Approx. 6 p.m. | 18th Green

A-Z INFORMATION

SECURITY POLICY

Due to recent events and heightened security across our nation, the PGA TOUR and the Travelers Championship have updated the Security Policy to include mandatory screening of all patrons, sponsors, volunteers, media and vendors attending or working the event.

Officials are asking everyone to participate in making the event safe and enjoyable by being aware of their surroundings during their visit to a PGA TOUR event. Should a person see an activity that might be unusual or suspicious, they're urged to notify security personnel or Tournament Official working the event.

Everyone is urged to keep a simple phrase in mind: "See something, say something."

Since the safety and well-being of everyone is of the utmost importance, please adhere to standard tournament policies. Listed below is the outline of the policies and procedures that will be enforced at the Travelers Championship.

Bag Inspection

All items are subject to search. Item inspection will be performed at all Admission Gates while gates are open.

The following bags are **PERMITTED** on tournament grounds:



Prohibited Items

The following items are **PROHIBITED** at the Travelers Championship and must be returned to your vehicle:



Clear Tote Bags, Plastic, Vinyl or Other Carry Items Larger than 12" x 6" x 12" (In their natural state)



Camera Bags



Cameras (Thurs - Sun) & Lens Larger than 6" (Mon - Wed)



Selfie Sticks and GoPoles



Chair Bags



Opaque Bags Larger than 6" x 6" x 6" (In their natural state)



Backpacks



Video Cameras



Posters, Signs or Banners



Binocular Case



Tinted Plastic Bag



Lawn or Oversized Chairs



Weapons of Any Kind



Plastic, Metal or Glass Cups, Cans or Containers



Clear Backpack



Printed Pattern Plastic Bag



Bicycles



Seat Cushions



Computers or Laptops



Mesh Synch Bag



Coolers of Any Kind



Radios, TV's, or Other Electronic Noise Producing Items



Fireworks, Laser Pointers or Other Explosives



Whistles, Horns or Noise Makers



Pets (with the exception of Service Animals)



Outside Food or Beverage (Except for Medical or Infant Needs)

Other prohibited items include:

Any other illegal substances or items deemed unlawful or dangerous by the PGA TOUR/Tournament Security Officials.

An exception will be made for fans needing to bring medical supplies into the tournament. These medically necessary items will be permitted after proper inspection at one of the admission gates.

Permitted Items

The following items **will be** allowed at the tournament:



Opaque Bags Not to Exceed 6" x 6" x 6" (In their natural state)



1-Gallon Clear, Resealable Plastic Bag



Clear Tote Bags, Plastic, Vinyl or Other Carry Items Not to Exceed 12" x 6" x 12" (In their natural state)



Medically Necessary and Infant Diaper Bags



Still Camera without Case & Lens Smaller than 6" (Mon - Wed)



Collapsible Chair without Chair Bag



Mobile Phones, Tablets, PDA's on Silent Mode (Please see Mobile Device Policy for more information)



Portable Radio with Headset



Binoculars without Case



Umbrella without Sleeve



Infant Supplies (Infant must be with Carrier)



Personal transportation devices for mobility aid such as a motorized wheelchair or scooter

SPECIAL ASSISTANCE SHUTTLE

On-course Special Assistance Shuttle stops include Main Gate, 18 Concessions and 18 Fairway Crosswalk. Hours of operation are Wednesday - Sunday 7:00 a.m. to 7:00 p.m. Special Assistance Shuttle is provided by Oak Hill.

TEXTING PROGRAM (HOW CAN WE HELP?)

The tournament has implemented a text communications system that can be used for guest services and operational issues. Signage will be located around the course with this information.

Text "Birdie" <space> issue and location to 69050

TICKETS - COMPLIMENTARY ADMISSION PROGRAMS



MILITARY FREE ADMISSION



VETERANS FREE ADMISSION



KIDS FREE ADMISSION

A-Z INFORMATION

WEATHER

Weather in Connecticut can sometimes be unpredictable. Please take the necessary precautions to avoid being uncomfortable while watching the tournament. This includes wearing appropriate and comfortable clothing and footwear, bringing a visor or hat, carrying an umbrella and applying suntan lotion. Watch the leader boards for "Weather Warnings." In the event of severe weather, Travelers Championship spectators will be kept informed of current conditions.

WILL CALL

The Travelers Championship Will Call office will be available during tournament week, Monday, June 18 - Sunday, June 24. The Will Call office is located on Golf Club Road, 1/10 of a mile south of the entrance to the General Parking Lot. In order to pick up your credentials, all guests will be required to show a photo ID.

WILL CALL HOURS

Monday: 7 a.m. – 6 p.m.

Tuesday: 7 a.m. – 6 p.m.

Wednesday: 4:30 a.m. – 6 p.m.

Thursday: 6 a.m. – 6 p.m.

Friday: 6 a.m. – 7 p.m.

Saturday: 7 a.m. – 7 p.m.

Sunday: 7 a.m. – 4 p.m.



TRAVELERS CHAMPIONSHIP



**MAPS & HOSPITALITY
INFORMATION**

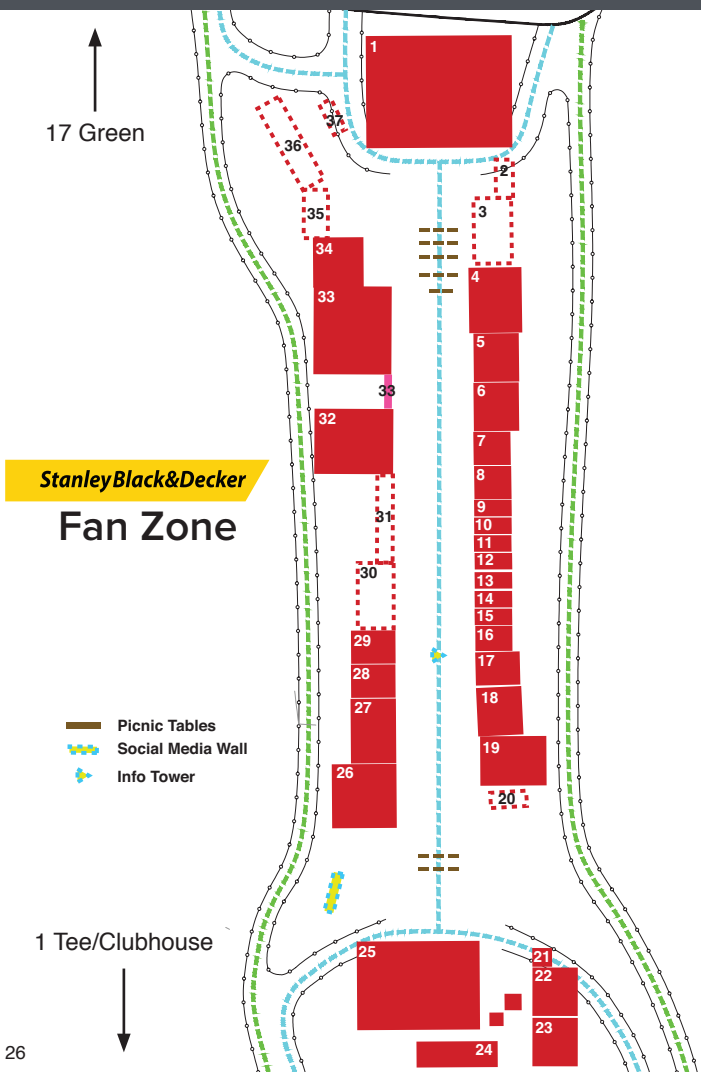

FAN ZONE CLIENTS

- 1 Liberty Bank Concert Series Stage
- 2 NBC Connecticut - WVIT
- 3 XFINITY
- 4 The Grey Goose Patio
- 5 Skechers Performance
- 6 Trinity Health Of New England
- 7 PGA TOUR Must-See Moments
- 8 iHeartMedia
- 9 iHeart Communities
- 10 Birdies for Charity
- 11 Operation Recognize
- 12 AARP Community Programs
- 13 Renewal by Andersen
- 14 Armor Shield Exteriors, LLC
- 15 Massage Envy
- 16 Volunteer Appreciation Station
- 17 Aer Lingus/Bradley International Airport
- 18 Stryker Mobility Zone
- 19 Titleist Demo Center /
GOLFTEC Swing Analysis
- 20 WTNH News 8
- 21 Family Care Station
- 22 The Hole in the Wall Gang Camp
- 23 LEGO®
- 24 Obstacle Course and Rockwall
- 25 Farmington Bank Mini Golf Course
- 26 Bridgestone Performance Center
- 27 Ben & Jerry's Ice Cream
- 28 Stanley Black & Decker
- 29 Drink Stand & Bar
- 30 Bear's Smokehouse BBQ
- 31 FedExCup Letters
- 32 Fan Zone Concessions
- 33 Course Map
- 34 Travelers
- 35 CNET & Travelers Insurance
- 36 Mohegan Sun
- 37 Ford Motor Company
- 38 WFSB

FAN ZONE CLIENTS A-Z

- | | |
|--|----|
| AARP Community Programs | 12 |
| Aer Lingus/Bradley International Airport | 17 |
| Armor Shield Exteriors, LLC | 14 |
| Bear's Smokehouse BBQ | 30 |
| Ben & Jerry's Ice Cream | 28 |
| Birdies for Charity | 10 |
| Bridgestone Performance Center | 26 |
| CNET & Travelers Insurance | 35 |
| Course Map | 33 |
| Drink Stand & Bar | 29 |
| Family Care Station | 21 |
| Fan Zone Concessions | 32 |
| Farmington Bank Mini Golf Course | 25 |
| FedExCup Letters | 31 |
| Ford Motor Company | 37 |
| iHeart Communities | 9 |
| iHeartMedia | 8 |
| LEGO® | 23 |
| Liberty Bank Concert Series Stage | 1 |
| Massage Envy | 15 |
| Mohegan Sun | 36 |
| NBC Connecticut - WVIT | 2 |
| Obstacle Course and Rockwall | 24 |
| Operation Recognize | 11 |
| PGA TOUR Must-See Moments | 7 |
| Renewal by Andersen | 13 |
| Skechers Performance | 5 |
| Stanley Black & Decker | 27 |
| Stryker Mobility Zone | 18 |
| The Grey Goose Patio | 4 |
| The Hole in the Wall Gang Camp | 22 |
| Titleist Demo Center /
GOLFTEC Swing Analysis | 19 |
| Travelers | 34 |
| Trinity Health Of New England | 6 |
| Volunteer Appreciation Station | 16 |
| WFSB | 38 |
| WTNH News 8 | 20 |
| XFINITY | 3 |

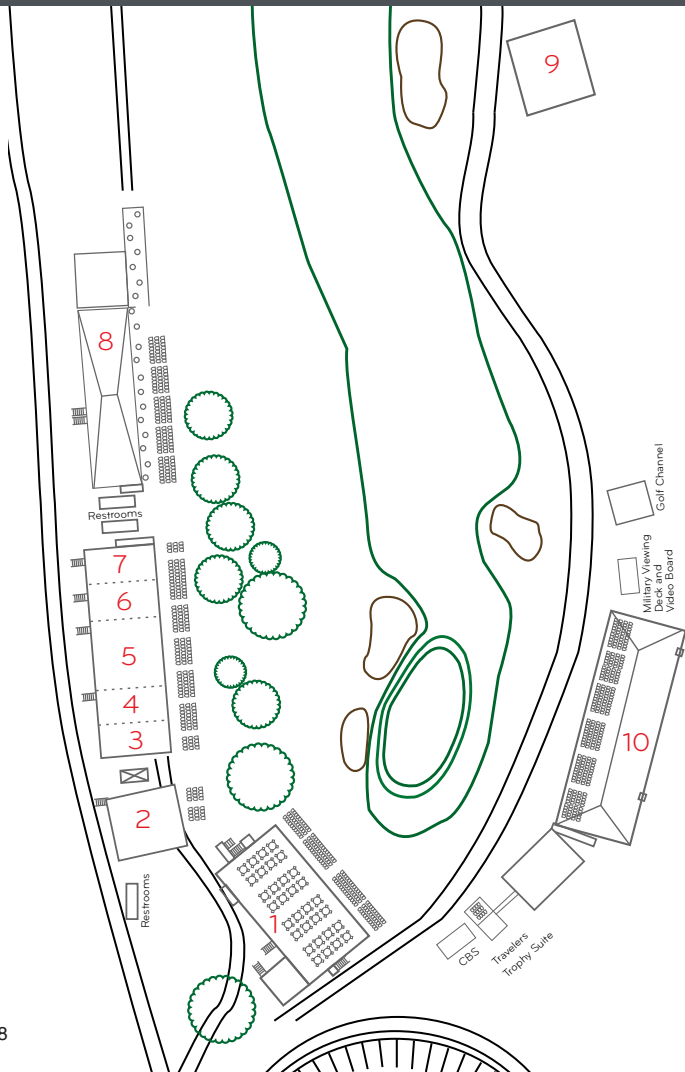

CLIENT/VENUE NAME

LOCATION

- | | |
|----------------------------------|--------------------------|
| 1. Aetna Greenside Club | Corporate Row |
| 2. Hospital for Special Care | Corporate Row |
| 3. Robinson+Cole | Corporate Row |
| 4. Trinity Health Of New England | Corporate Row |
| 5. Travelers | Corporate Row |
| 6. Webster Bank | Corporate Row |
| 7. CT DECD | Corporate Row |
| 8. Mohegan Sun Sponsor Club | 18 Fairway, Player Right |
| 9. Stanley Black & Decker Lounge | 18 Fairway, Player Left |
| 10. Aer Lingus Champions Club | 18 Green |

TRAVELERS FACILITIES

- | | |
|------------------------------------|-----------------|
| Travelers Trophy Suite Hospitality | 18 Green |
| Travelers Corporate Row | Corporate Row |
| Travelers 360 | 15 Green/18 Tee |



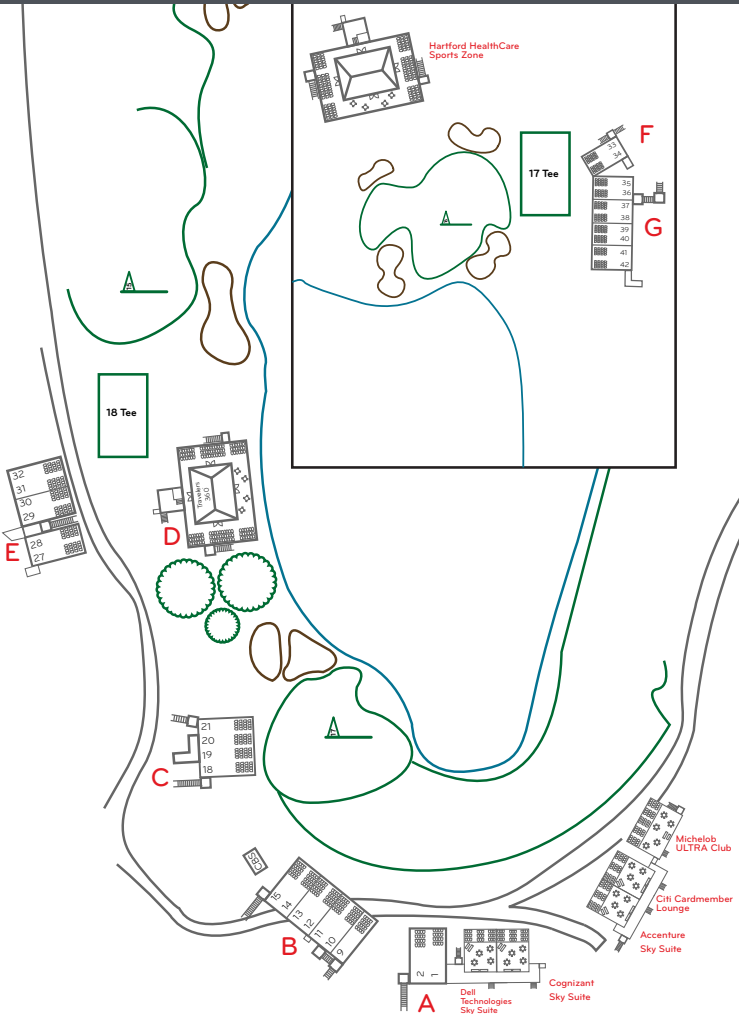

MICHELOB ULTRA CLUB - 17 GREEN

Open to the public

17 GREEN SKY SUITE CLIENTS

Accenture Cognizant
Citi Cardmember Lounge* Dell Technologies
**Open to all Citi card holders*

17 GREEN SKYBOX CLIENTS

SKYBOX A

1. IBM
2. CDW

SKYBOX B

9. KeyBank
10. Hartford Courant Media Group
11. Eversource Energy
12. Halloran & Sage, LLP
13. Kelser Corporation
14. iHeartMedia
15. Larsen & Toubro Infotech (LTI)

SKYBOX C

18. Bank of America
19. Atlantic Data Security
20. WFSB
21. USA Hauling & Recycling Inc.

17 TEE SKYBOX CLIENTS

SKYBOX F

33. & 34. ebm-papst Inc.

SKYBOX G

35. Kamco Supply
36. **DAILY**
FRI: KPMG LLP
SAT: Chase Private Client
SUN: RICOH
37. **DAILY**
WED: Transamerica
THU: Fuss & O'Neill, Inc.
FRI: Centurion Wealth Management
SAT: GreatBlue Research, Inc.
SUN: Centurion Wealth Management

38. DAILY

- WED: Transamerica
THU: MJP Wealth Advisors
FRI: HUBBELL INC.
SAT: EMCOR Services
SUN: New England Mechanical
DATTCO

15 GREEN/18 TEE SKYBOX CLIENTS

SKYBOX E

27. & 28. Nestlé Purina
29. **DAILY**
WED: WTIC NewsTalk 1080
THU: ACBB
FRI: UI, SCG and CNG
SAT: OUTFRONT MEDIA
SUN: UI, SCG and CNG
30. **DAILY**
WED: Sheraton Hartford South
THU: Aflac
FRI: UI, SCG and CNG
SUN: UI, SCG and CNG
31. **DAILY**
WED: UI, SCG and CNG
THU: Anthem Blue Cross and Blue Shield
FRI: Virtus Investment Partners
SAT: NetSource, Inc.
SUN: Blake Group
32. **DAILY**
WED: MahoneySabol
THU: Marcum LLP
FRI: McCarter & English
SAT: Minuteman Press Hartford
SUN: Creative Dimensions Signs & Exhibits

39. DAILY

- THU: Litchfield Cavo, LLP
FRI: DANE STREET
SAT: BarnumPlans.com
SUN: OUTFRONT MEDIA

40. DAILY

- THU: Comcast Spotlight
FRI: Nutanix
SAT: Amstel Light
SUN: Amstel Light

41. DAILY

- THU: Liberty Bank
FRI: Hewlett Packard Enterprise
SAT: Hewlett Packard Enterprise
SUN: LAZ Parking

42. DAILY

- THU: Carousel/Avaya
FRI: Yale New Haven Health
SAT: Metals Testing Company
SUN: LAZ Parking

CLIENT/VENUE NAME

ACBB
 Accenture
 Aer Lingus Champions Club
 Aetna Greenside Club
 Aflac
 Amstel Light
 Anthem Blue Cross and Blue Shield
 Atlantic Data Security
 Bank of America
 BarnumPlans.com
 Blake Group
 Carousel/Avaya
 CDW
 Centurion Wealth Management
 Chase Private Client
 Citi Cardmember Lounge
 Cognizant
 Comcast Spotlight
 Creative Dimensions Signs & Exhibits
 CT DECD
 DANE STREET
 DATTCO
 Dell Technologies
 ebm-papst Inc.
 EMCOR Services New England Mechanical
 Eversource Energy
 Fuss & O'Neill, Inc.
 GreatBlue Research, Inc.
 Halloran & Sage, LLP
 Hartford Courant Media Group
 Hartford HealthCare Sports Zone
 Hewlett Packard Enterprise
 Hospital for Special Care
 HUBBELL INC.
 IBM
 iHeartMedia
 Kamco Supply

LOCATION

15 Green/18 Tee
 17 Green
 18 Green
 Corporate Row
 15 Green/18 Tee
 17 Tee
 15 Green/18 Tee
 17 Green
 17 Green
 17 Tee
 15 Green/18 Tee
 17 Green
 17 Green
 17 Tee
 15 Green/18 Tee
 Corporate Row
 17 Tee
 17 Tee
 17 Green
 17 Tee
 17 Tee
 17 Green
 17 Tee
 17 Green
 17 Green
 15 Tee/16 Green
 17 Tee
 Corporate Row
 17 Tee
 17 Green
 17 Green
 17 Tee

CLIENT/VENUE NAME

Kelser Corporation
 KeyBank
 KPMG LLP
 Larsen & Toubro Infotech (LTI)
 LAZ Parking
 Liberty Bank
 Litchfield Cavo, LLP
 MahoneySabol
 Marcum LLP
 McCarter & English
 Metals Testing Company
 Michelob ULTRA Club
 Minuteman Press Hartford
 MJP Wealth Advisors
 Mohegan Sun Sponsor Club
 Nestlé Purina
 NetSource, Inc.
 Nutanix
 OUTFRONT MEDIA
 RICOH
 Robinson+Cole
 Sheraton Hartford South
 Stanley Black & Decker Lounge
 Transamerica
 Travelers
 Travelers Trophy Suite Hospitality
 Trinity Health Of New England
 UI, SCG and CNG
 USA Hauling & Recycling Inc.
 Virtus Investment Partners
 Webster Bank
 WFSB
 WTIC NewsTalk 1080
 Yale New Haven Health

LOCATION

17 Green
 17 Green
 17 Tee
 17 Green
 17 Tee
 17 Tee
 17 Tee
 15 Green/18 Tee
 15 Green/18 Tee
 15 Green/18 Tee
 17 Tee
 17 Green
 15 Green/18 Tee
 17 Tee
 18 Fairway, Player Right
 15 Green/18 Tee
 17 Tee, 15 Green/18 Tee
 17 Tee
 17 Tee, 15 Green/18 Tee
 17 Tee
 Corporate Row
 15 Green/18 Tee
 18 Fairway, Player Left
 17 Tee
 Corporate Row
 18 Green
 Corporate Row
 15 Green/18 Tee
 17 Green
 15 Green/18 Tee
 Corporate Row
 17 Green
 15 Green/18 Tee
 17 Tee



TRAVELERS CHAMPIONSHIP

2018 COURSE MAP

AMENITIES

- ATMs
 - Family Care Station
 - Concessions
 - Drink Stands
 - Medical provided by [Travelers Health](#) | [Travelers Pharmacy](#)
 - Merchandise Tent
 - Molson-Coors Tournament Ambassadors
 - PURINA Bleachers
 - Oak Hill Special Assistance Shuttle
 - Off-Site ADA Shuttle Drop
 - Restrooms*
- * Each location includes a handicap accessible restroom
A dashed red line denotes pedestrian crosswalks

EXPERIENCES

- FARMINGTON BANK Kids Zone & Mini Golf Course
- GREY GOOSE Patio
- Stanley Black & Decker Fan Zone
- Social Media Wall
- stryker Health Walk

OPEN TO THE PUBLIC

- AMSTEL LIGHT Public House
- Citi Cardmember Lounge Must be 21 or over to enjoy
- Hartford HealthCare Sports Zone
- ULTRA CLUB
- Patriots' Outpost presented by [Trinity Health](#)
Military Service Members and U.S. Veterans
- Stanley Black & Decker Lounge

PRIVATE VENUES

- Aer Lingus Champions Club
- aetna Greenside Club
- Clubhouse
- Corporate Row
- Media Center
- Pro-Am Tent
- Sky Suite
- Skyboxes
- Molson-Coors Sponsor Club
- The First Tee of Connecticut
- Travelers 360
- Travelers Trophy Suite
- Hartford HealthCare Volunteer Headquarters

Upper 18 Area

- ATMs
- Concessions
- Molson-Coors Tournament Ambassadors
- Oak Hill Special Assistance Shuttle
- Off-Site ADA Shuttle Drop
- Restrooms*

Main Entrance

- ATMs
- Molson-Coors Tournament Ambassadors
- Oak Hill Special Assistance Shuttle
- PURINA Bleachers
- Restrooms*

Practice Facility

- Concessions
- Molson-Coors Tournament Ambassadors
- PURINA Bleachers
- Restrooms*

9 Green Area

- AMSTEL LIGHT Public House
- ATMs
- Drink Stands
- Merchandise Tent
- PURINA Bleachers

Stanley Black & Decker Fan Zone

- ATMs
- Family Care Station
- Concessions
- Drink Stands
- FARMINGTON BANK Kids Zone & Mini Golf Course
- GREY GOOSE Patio
- Molson-Coors Tournament Ambassadors
- PURINA Bleachers
- Social Media Wall
- Restrooms*



Gold Lot (Lot B)

Main Entrance

9th Hole Entrance

Green Lot

Sponsor Valet (Gray Lot)

Red Lot (VIP/Media)



TRAVELERS CHAMPIONSHIP

www.TravelersChampionship.com

[#TravelersChamp](https://twitter.com/TravelersChamp)

HOW CAN WE HELP?

**Text “BIRDIE” <space>
issue and location to 69050**

Volunteers Sponsored by

Hartford
HealthCare
Connect to healthier.™